

QuickShot™ II

For portable airless spraying of architectural paints and coatings.

Not approved for use in explosive atmospheres or hazardous (classified) locations.



Important Safety Instructions

Read all warnings and instructions in this manual and related manuals before using the equipment. Be familiar with the proper control and usage of the equipment. Save these instructions.



Important Medical Information

Read the medical alert card provided with the gun. It contains injection injury treatment information for a doctor. Keep it with you when operating the equipment.

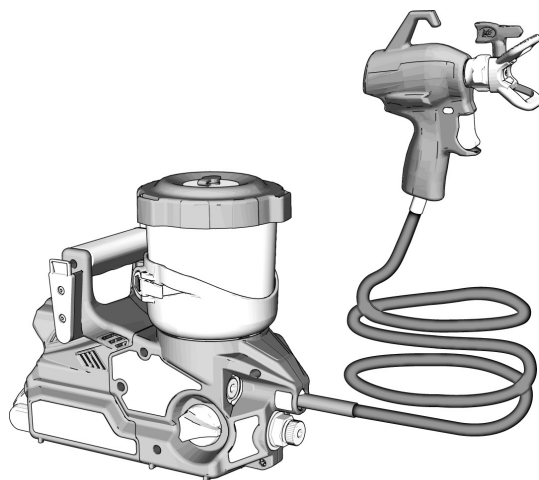

graco.com/contact

105410a

CONTENTS



Models	3
Translated Manuals	4
Important Grounding Information	6
Safety Symbols	7
Warnings	8
Technical Specifications	12
Component Identification	14
Know Your Controls	16
Grounding Instructions	18
Oil-based or Flammable Materials	18
Pails	19
Setup	20
Sprayer Setup	20
Spray Tip Installation and Removal	21
Belt Setup	22
Startup	24
Operation	26
Pressure Relief Procedure	26
Prepare to Spray	26
Adjust Flow Control	27
Select Tip and Pressure	27
Adjust Spray Tip	28
Practice Spray Techniques	28
Aim the Spray Gun	28
Trigger Gun After Starting Stroke	29
Test Spray Pattern Quality	29
Clear Tip Clog	29
Refill Cup	30
Prevent Clogs During Pause	32
Cleanup	33
Clean the Sprayer	33
Clean the Filter	35
Prepare Sprayer for Storage	36
Recycling and Disposal	37
Rechargeable Battery Disposal	37
End of Product Life	37
Troubleshooting	38
Replacement Parts	44
California Proposition 65	47

MODELS

The part numbers reflect distinct features and characteristics of the QuickShot™ II.

QUICKSHOT II MODELS AND APPROVALS

Maximum Working Pressure: 2000 psi (14 MPa, 138 bar)

APPROVAL	MODEL	DESCRIPTION	CHARGER VOLTAGE	TIP FAMILY	TIP SIZE
 Intertek 110474 Certified to CAN/CSA C22.2 No. 68 Conforms to UL 1450	26E006	Ultra QuickShot II NA	120 V	FFLPxxx	0.008–0.016 in. (0.20–0.41 mm)
	826319	Ultimate QuickShot II NA			
	26E007	Ultra QuickShot II UK	230 V		
	26E008	Ultra QuickShot II			
	26E009	Ultra QuickShot II Japan	100 V		
	26E010	Ultra QuickShot II Korea	230 V		
	26E011	Ultra QuickShot II ANZ			

Compatible with the following DeWALT batteries: DCB183 and DCB203

Table 1-1: Related Manuals for QuickShot II

ENGLISH MANUAL	DESCRIPTION
N/A	DeWALT charger manual

TRANSLATED MANUALS

Additional language documents are available to support all regions where the QuickShot™ II is sold. Find any available translations at www.graco.com.

Table 2-1: Translations for QuickShot II Manual

LANGUAGE	MANUAL NUMBER
Arabic	X048114AR
Bulgarian	X048114BG
Chinese	X048114ZH
Croatian	X048114HR
Czech	X048114CZ
Danish	X048114DA
Dutch	X048114NL
English	X048114EN
Estonian	X048114ET
Finnish	X048114FI
French	X048114FR
German	X048114DE
Greek	X048114EL
Hungarian	X048114HU
Italian	X048114IT
Japanese	X048114JA
Korean	X048114KO
Latvian	X048114LV
Lithuanian	X048114LT
Norwegian	X048114NO
Polish	X048114PL
Romanian	X048114RO
Slovakian	X048114SK
Slovenian	X048114SL

TRANSLATED MANUALS



LANGUAGE	MANUAL NUMBER
Spanish	X048114ES
Swedish	X048114SV
Turkish	X048114TR

IMPORTANT GROUNDING INFORMATION

The following information is intended to help you understand when to use the grounding wire provided with your sprayer.

Please read the information on the material container label to determine if it is oil-based or flammable. Ask for a Safety Data Sheet (SDS) from your supplier. The container label and SDS will explain the contents of the material and the specific precautions related to it.

Paints, coatings and clean-up materials generally fit into one of the following **3 basic types**:

GROUNDING WIRE AND PLUG REQUIRED?	TYPE OF MATERIAL
No	WATER-BASED: The container label should indicate that the material can be cleaned up with soap and water.
 Yes	OIL-BASED: The container label should indicate that the material is COMBUSTIBLE and can be cleaned up with mineral spirits or non-flammable paint thinner. Use oil-based material outdoors or in a well-ventilated indoor area with a flow of fresh air. See the safety warnings in this manual. Follow Grounding Instructions when using this type of material.
 Yes	FLAMMABLE: This type of material contains flammable solvents such as xylene, toluene, naphtha, MEK, lacquer thinner, acetone, denatured alcohol, and turpentine. The container label should indicate that this material is FLAMMABLE. Use flammable materials outdoors or in a well-ventilated area with a flow of fresh air. Follow Grounding Instructions when using this type of material.

SAFETY SYMBOLS

The following safety symbols appear throughout this manual and on warning labels. Read the table below to understand what each symbol means.

SYMBOL	MEANING
	Equipment Misuse Hazard
	Fire and Explosion Hazard
	Skin Injection Hazard
	Skin Injection Hazard
	Splash Hazard
	Toxic Fluid or Fumes Hazard
	Do Not Place Hands or Other Body Parts Near Fluid Outlet
	Do Not Put Hand in Front of Spray Tip

SYMBOL	MEANING
	Do Not Stop Leaks with Hand, Body, Glove or Rag
	Eliminate Ignition Sources
	Follow Pressure Relief Procedure
	Ground Equipment
	Read Manual
	Ventilate Work Area
	Wear Personal Protective Equipment



Safety Alert Symbol

This symbol indicates: Attention! Become Alert! Look for this symbol throughout the manual to indicate important safety messages.

WARNINGS

The following warnings apply throughout this manual. Read, understand, and follow the warnings before using this equipment. Failure to follow these warnings can result in serious injury.

WARNING



FIRE AND EXPLOSION HAZARD

Flammable fumes, such as solvent and paint fumes, in work area can ignite or explode. To help prevent fire and explosion:



- Do not spray flammable or combustible materials near an open flame or sources of ignition such as cigarettes, motors, and electrical equipment.



- Do not use a paint or a solvent containing halogenated hydrocarbons.



- Keep spray area well-ventilated. Keep a good supply of fresh air moving through the area.

- Sprayer generates sparks. Keep pump assembly in a well-ventilated area when spraying, flushing, cleaning, or servicing. Do not spray pump assembly.

- Do not smoke in the spray area or spray where sparks or flame is present.

- Do not operate light switches, engines, or similar spark producing products in the spray area.

- Keep area clean and free of paint or solvent containers, rags, and other flammable materials.

- Know the contents of the paints and solvents being sprayed. Read all Safety Data Sheets (SDSs) and container labels provided with the paints and solvents. Follow the paint and solvent manufacturer's safety instructions.

- Keep a working fire extinguisher in the work area.

Oil-based or Flammable Materials

Paint or solvent flowing through the equipment is able to result in static electricity. Static electricity creates a risk of fire or explosion in the presence of paint or solvent fumes. To help prevent fire and explosion when using oil-based or flammable materials:

- Connect the grounding wire and plug to a true earth ground.

- If there is static sparking or if you feel a static charge, stop operation immediately. Do not use sprayer until you identify and correct the problem.

- All parts of the spray system, including the pump, hose assembly, spray gun, and objects in and around the spray area shall be properly grounded to protect against static discharge and sparks. Use Graco conductive or grounded high-pressure airless paint sprayer hoses. Follow **Grounding Instructions**.

- Verify that all containers and collection systems are grounded to prevent static discharge. Do not use pail liners unless they are anti-static or conductive.



WARNING



SKIN INJECTION HAZARD

High-pressure spray is able to inject toxins into the body and cause serious injury that can result in amputation. In the event that injection occurs, **get immediate surgical treatment.**



- Do not aim the gun at, or spray, any person or animal.
- Keep hands and other body parts away from the discharge. For example, do not try to stop leaks with any part of the body.
- Always use the spray tip guard. Do not spray without spray tip guard in place.
- Use Graco spray tips.
- Use caution when cleaning and changing spray tips. In the case where the spray tip clogs while spraying, follow the **Pressure Relief Procedure** for turning off the unit and relieving the pressure before removing the spray tip to clean.
- Equipment maintains pressure after power is turned off. Do not leave the equipment energized or under pressure while unattended. Follow the **Pressure Relief Procedure** when the equipment is unattended or not in use, and before servicing, cleaning, or removing parts.
- Check hoses and parts for signs of damage. Replace any damaged hoses or parts.
- This system is capable of producing 2000 psi (138 bar, 13.8 MPa). Use Graco parts or accessories that are rated a minimum of 2000 psi (138 bar, 13.8 MPa).
- Always engage the trigger lock when not spraying. Verify the trigger lock is functioning properly.
- Verify that all connections are secure before operating the unit.
- Know how to stop the unit and bleed pressure quickly. Be thoroughly familiar with the controls.

 **WARNING**



EQUIPMENT MISUSE HAZARD

Misuse can cause death or serious injury.

- Always wear appropriate gloves, eye protection, and a respirator or mask when painting.
- Do not operate or spray near children. Keep children away from equipment at all times.
- Do not overreach or stand on an unstable support. Keep effective footing and balance at all times.
- Stay alert and watch what you are doing.
- Do not operate the unit when fatigued or under the influence of drugs or alcohol.
- Do not kink or overbend the hose.
- Do not expose the hose to temperatures or to pressures in excess of those specified by Graco.
- Do not use the hose as a strength member to pull or lift the equipment.
- Do not alter or modify equipment. Alterations or modifications may void agency approvals and create safety hazards.
- Make sure all equipment is rated and approved for the environment in which you are using it.



MOVING PARTS HAZARD

Moving parts can pinch, cut, or amputate fingers and other body parts.



- Keep clear of moving parts.
- Do not operate equipment with protective guards or covers removed.
- Equipment can start without warning. Before checking, moving, or servicing equipment, follow the **Pressure Relief Procedure** and disconnect all power sources.



PRESSURIZED ALUMINUM PARTS HAZARD

Use of fluids that are incompatible with aluminum in pressurized equipment can cause serious chemical reaction and equipment rupture. Failure to follow this warning can result in death, serious injury, or property damage.

- Do not use 1,1,1-trichloroethane, methylene chloride, other halogenated hydrocarbon solvents or fluids containing such solvents.
- Do not use chlorine bleach.
- Many other fluids may contain chemicals that can react with aluminum. Contact your material supplier for compatibility.

**WARNING****TOXIC FLUID OR FUMES HAZARD**

Toxic fluids or fumes can cause serious injury or death if splashed in the eyes or on skin, inhaled, or swallowed.

- Read Safety Data Sheets (SDSs) to know the specific hazards of the fluids you are using.
- Store hazardous fluid in approved containers, and dispose of it according to applicable guidelines.

**PERSONAL PROTECTIVE EQUIPMENT**

Wear appropriate protective equipment when in the work area to help prevent serious injury, including eye injury, hearing loss, inhalation of toxic fumes, and burns. Protective equipment includes but is not limited to:

- Protective eyewear and hearing protection.
- Respirators, protective clothing, and gloves as recommended by the fluid and solvent manufacturer.

TECHNICAL SPECIFICATIONS

The table provides important information related to the QuickShot™ II, including product attributes, measurements, and performance characteristics that support the use of the equipment.

Table 6-1: Technical Specifications for QuickShot II

QUICKSHOT II SPRAYER		
	U.S.	METRIC
Maximum working pressure	2000 psi	14 MPa, 138bar
Weight	6.4 lb	2.9 kg
Dimensions		
Length	12 in.	30.5 cm
Width	6 in.	15.2 cm
Height	10.5 in.	26.7 cm
Temperature		
Storage temperature range	32° to 113° F	0° to 45° C
Operating temperature range	40° to 90° F	4° to 32° C
Storage humidity range	0 percent to 95 percent relative humidity, non-condensing	
Noise		
Sound pressure level	81.0 dB(A)	
Sound power level	97 LwA Uncertainty K = 3 LwA	
Vibration level (measured in accordance with ISO 5349)	Vibration total value a_h = 9.45 ft/s ²	Vibration total value a_h = 2.88 m/s ²
Power		
Charger power source	100 - 120 VAC, 50 Hz, 15A, 1 Ø	
	230 VAC, 50 Hz, 16A, 1 Ø	
Battery Voltage (DC)	20 V MAX* 2.0 Ah Li-ion Compact Battery Pack DEWALT®	
Tips		
Maximum tip orifice	0.016 in.	0.41 mm

TECHNICAL SPECIFICATIONS

QUICKSHOT II SPRAYER		
	U.S.	METRIC
Notes		
<p>* Startup pressures and displacement per cycle may vary based on suction condition, discharge head, air pressure, and fluid type.</p> <p>** All fluid contact materials are FDA-compliant and meet the United States Code of Federal Regulations (CFR) Title 21 for repeated use in food-processing machinery. The pump user must verify that the construction materials meet their specific application requirements.</p> <p>All trademarks or registered trademarks are the property of their respective owners.</p>		

COMPONENT IDENTIFICATION

QUICKSHOT™ II

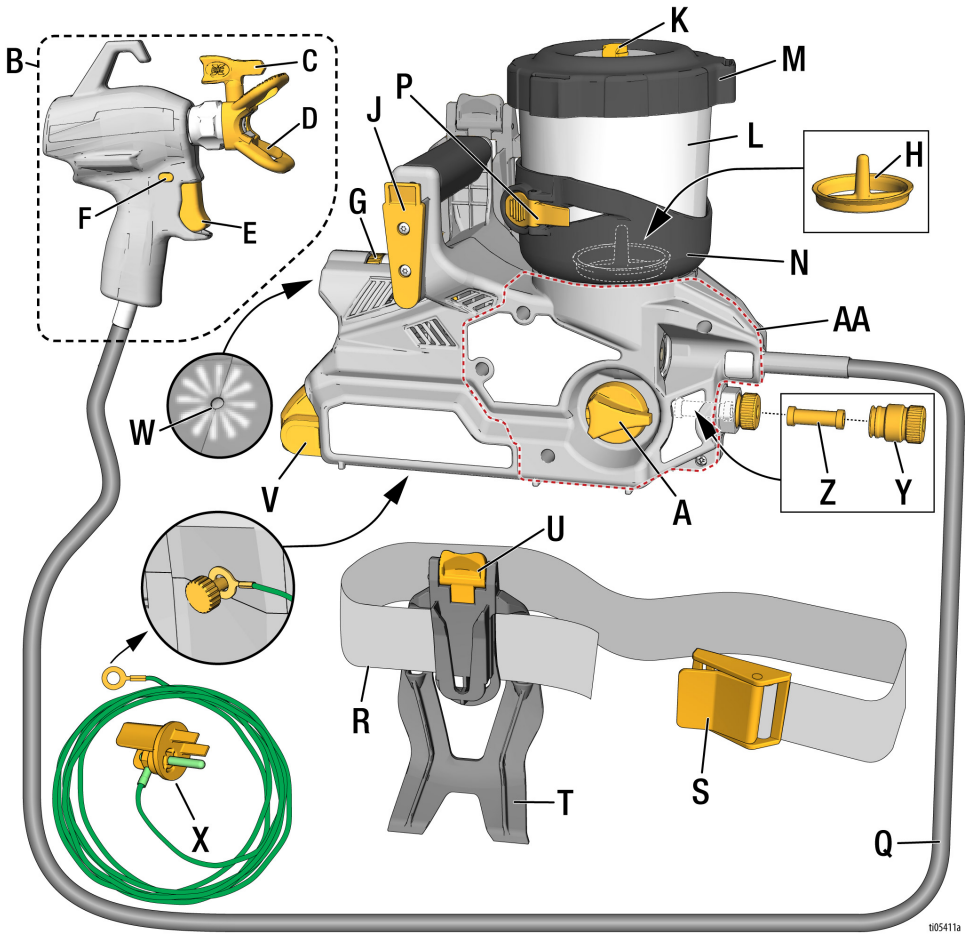



Figure 7-1: QuickShot II Diagram

105411a

COMPONENT IDENTIFICATION

A	Prime Knob
B	Spray Gun
C	Spray Tip (2 included)
D	Spray Tip Guard
E	Trigger
F	Trigger Lock
G	Flow Control
H	Cup Strainer
J	Belt Clip (on sprayer)
K	Storage Plug (2 included)
L	Cup
M	Cup Lid
N	Cup Support
P	Cup Release Lever
Q	Hose
R	Belt
S	Belt Latch
T	Belt Holster
U	Holster Release Clip
V	Battery
W	Diagnostic Light
X	Grounding Wire and Plug
Y	Pump Filter Cap
Z	Pump Filter
AA	ProConnect Access Door

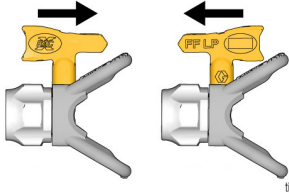
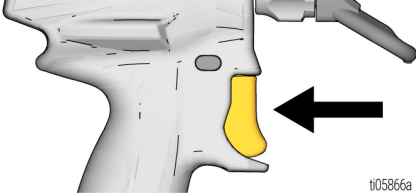
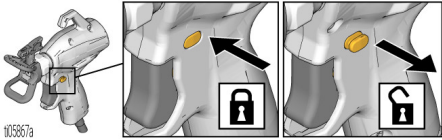
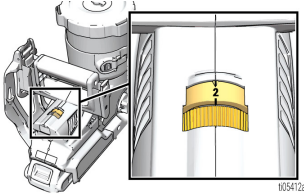

KNOW YOUR CONTROLS

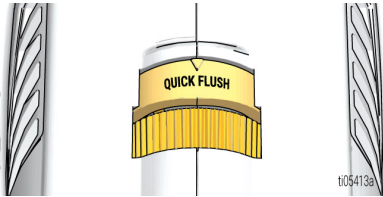
	<p>Prime Knob</p> <p>The Prime Knob directs fluid to either the Cup or the Spray Tip. When priming, the Prime Knob purges air from the pump. Your sprayer will not spray with air in the pump.</p> <p>Turn Prime Knob up to PRIME position when priming the sprayer or to relieve system pressure.</p> <p>Turn Prime Knob forward to SPRAY position to spray fluid.</p>
	<p>Spray Tip</p> <p>The Spray Tip is the key to airless spray technology. High-pressure paint pumped through the very small hole in the Spray Tip comes out as a spray.</p> <p>The Spray Tip has the ability to be reversed and quickly clear clogs.</p>
	<p>Trigger</p> <p>The Trigger controls the operation of the sprayer.</p>
	<p>Trigger Lock</p> <p>When the Trigger Lock is engaged, it prevents the Spray Gun from spraying.</p> <p>When the Trigger Lock is engaged, there is no visible red showing on the Trigger Lock. Engage Trigger Lock when not spraying.</p>
	<p>Flow Control</p> <p>The Flow Control allows you to slow down or speed up when spraying.</p>

	<p>Quick Flush</p> <p>Quick Flush is a cleaning mode intended to verify that the pump is properly cleaned. The Gun will open and close automatically when the trigger is pulled in Quick Flush mode.</p>
--	---

GROUNDING INSTRUCTIONS

Properly ground the QuickShot™ II sprayer to ensure optimal performance during use.

⚠ WARNING				
				
<p>The equipment must be grounded to reduce risk of static sparking. A static spark can cause fumes to ignite or explode. A good ground provides an escape wire for electric current.</p>				

OIL - BASED OR FLAMMABLE MATERIALS

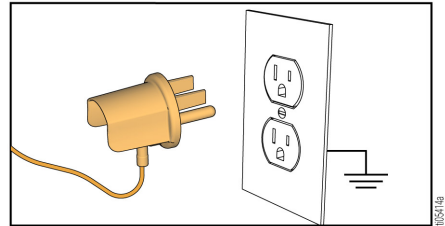
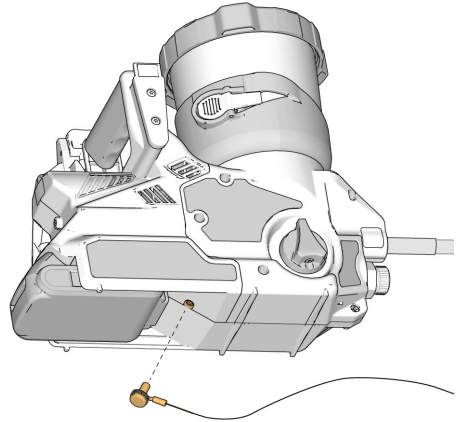

The sprayer is equipped with a Ground Wire and Plug. The Plug must be connected to a properly grounded electrical outlet when spraying or flushing oil-based or flammable materials, see **Important Grounding Information**. Move the sprayer away from the spray area when connecting the Ground Wire and Plug.

If the Grounding Wire is not long enough to reach a grounded electrical outlet, use a 3-wire grounded extension cord between the Plug and outlet.

P A I L S

Oil-based or flammable fluids: Follow local codes and regulations. Use only conductive metal pails, placed on a grounded surface such as concrete.

Do not place pail on a non-conductive surface, such as paper or cardboard, which interrupts grounding continuity.



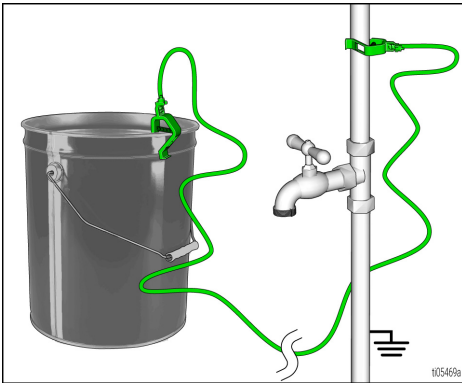

Always ground a metal pail: Connect a ground wire to the pail. Clamp one end to the pail and the other end to a true earth ground such as a water pipe.



SETUP

When using the equipment for the first time or after long term storage, follow the steps to prepare the QuickShot™ II for operation.

SPRAYER SETUP

⚠ WARNING			
			
<p>Flammable fumes (such as solvent and paint fumes) in work area can ignite or explode.</p> <p>See Grounding Instructions.</p> <p>Do not spray flammable or combustible liquids in a confined area. When spraying flammable or combustible materials:</p> <ul style="list-style-type: none">• Move entire sprayer to a well-ventilated area and away from flammable or combustible materials, including paints and solvents when refilling.• Keep material containers covered between cup refills.			

If spraying **oil-based or flammable** materials, review **Cleaning Fluid Capability** and follow **Grounding Instructions**.

NOTE:

Always pre-strain the paint before you fill the Cup.

1. Engage the Trigger Lock. Turn Prime Knob to the PRIME position.

2. Remove the Cup Lid from the Cup.

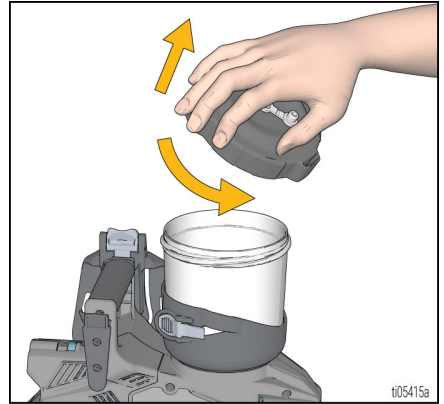

3. Verify the clean Cup Strainer is installed in the bottom of the Cup.

NOTE:

If the Cup Strainer is dirty or plugged, the sprayer will operate poorly or lose its prime.

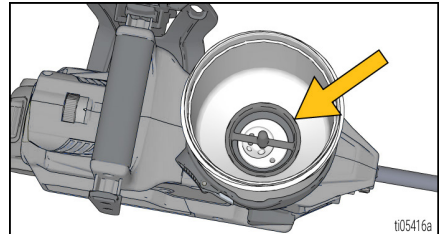

4. Fill Cup with paint and reinstall Cup Lid.

NOTE:

Do not shake materials to be used with this sprayer. Some fine finish lacquers and enamels trap air when shaken, which can affect sprayer performance. Stir the material or check the manufacturer's recommendation for the material being sprayed.

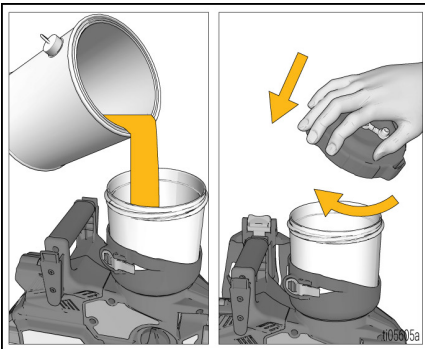

NOTE:

Storage Plug must be open while spraying to avoid an air lock and loss of prime. When storing the sprayer, it is optional to use the Storage Plug on top of the Cup Lid.

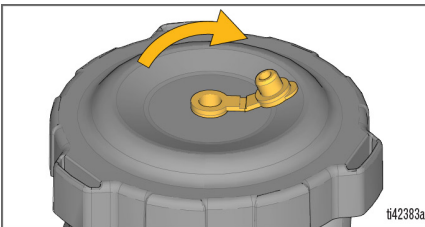

**SPRAY TIP
INSTALLATION AND
REMOVAL**

Properly install and remove a Spray Tip on the QuickShot II.

 WARNING			
			
<p>To avoid serious injury from skin injection, do not put your hand in front of the Spray Tip when installing or removing the Spray Tip.</p>			

NOTE:

For proper spraying operation use only Graco FFLP family of tips with your spray gun.

1. Perform **Pressure Relief Procedure**.
2. Remove battery from sprayer.
3. Use Spray Tip (A) to insert OneSeal™ (B) into Spray Tip Guard (C).

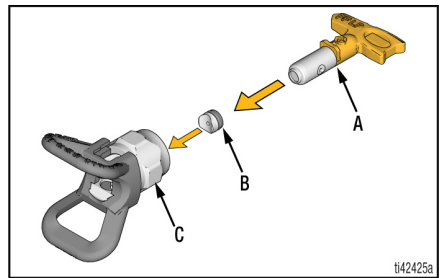

4. Insert Spray Tip into Spray Tip Guard.

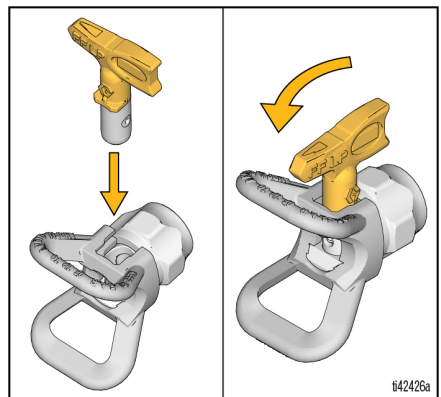

SETUP

5. Screw assembly onto Spray Gun and hand tighten.

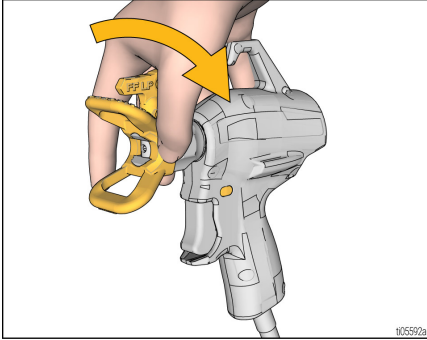

NOTE:

The Spray Gun has an integrated solvent gasket in the end of the gun (yellow) which allows for the use of the standard OneSeal™ (B) for all material applications.

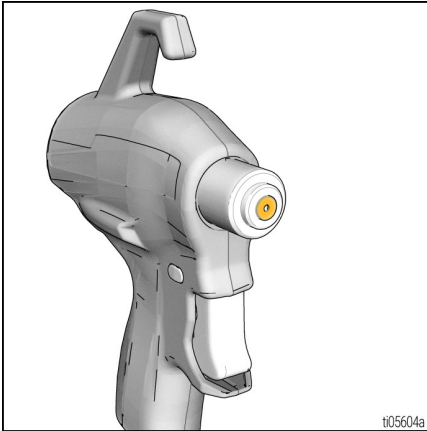

BELT SETUP

Properly prepare the belt setup for ease of use and transportation of the QuickShot™ II.

1. Install Belt Holder onto Belt in the orientation you prefer for ease of comfort and operation (left side, right side, or back side).

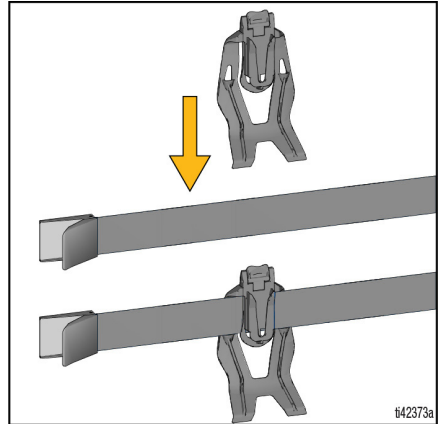

2. Attach the Belt on waist and tighten until snug. Close Belt Latch.

NOTE:

Tighten the belt fairly tight to ensure the sprayer is held securely during use.

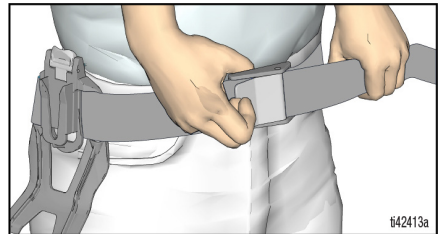

SETUP

3. Attach sprayer to Belt Holder in the orientation you prefer for ease of comfort and operation (hose facing forward or backward).

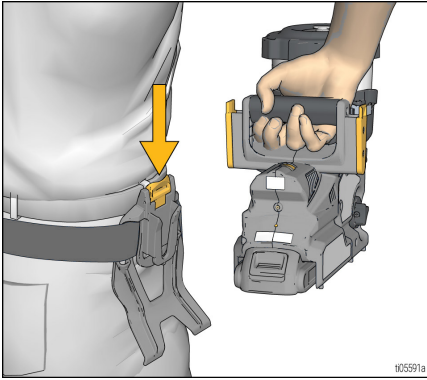

4. Spray Gun will hook on the outside of the sprayer as shown for hands-free mobility.

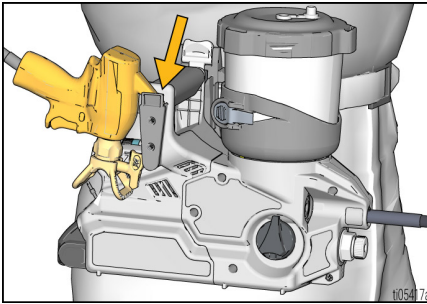

5. To remove sprayer from Belt, press the Holster Release Clip and pull up on the sprayer.

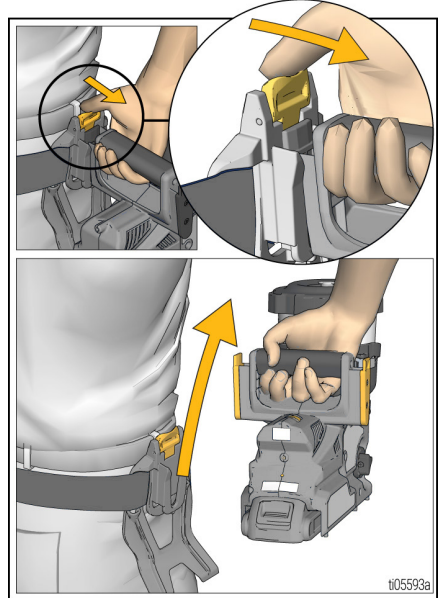

NOTICE

Never pull the sprayer around by the hose. Doing so can damage or disconnect the wire connections in the sprayer or Spray Gun.

STARTUP

Always start with a fully charged battery. See battery and charging information shipped with the sprayer.

⚠ WARNING			
			
<p>Replace and charge Battery only in a well-ventilated area and away from flammable or combustible materials, including paints and solvents. Do not splash or immerse battery or charger in water or solvents.</p>			

1. Disengage Trigger Lock and verify Prime Knob is pointed up in the PRIME position.

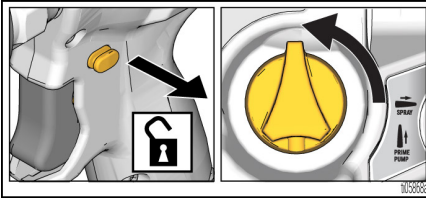

2. Turn the Spray Tip to UNCLOG position.

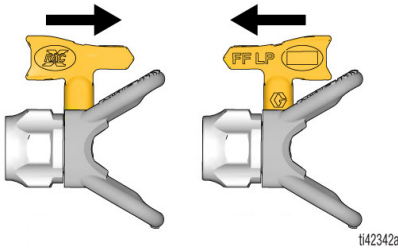

3. Install fully charged Battery onto sprayer.

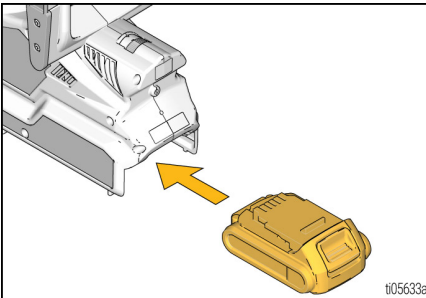

4. Verify Storage Plug is OPEN.

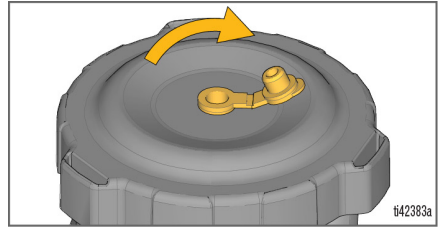

5. To prime the pump, point the Spray Gun into a waste pail and pull the Trigger for 10 seconds. This will purge air from the pump.

NOTE:

The Spray Gun is always open when the Trigger is pulled so a small amount of fluid may spray out while priming.

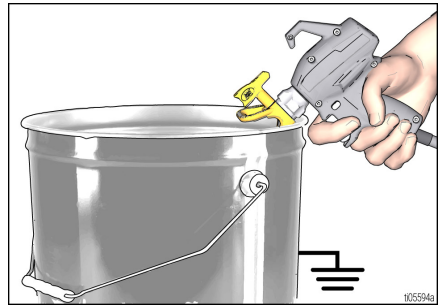

6. Turn the Prime Knob forward to SPRAY position.

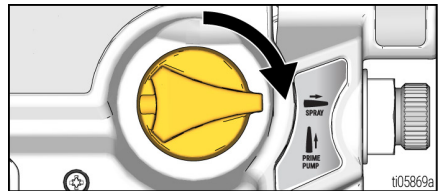

STARTUP

7. To prime the Hose and Spray Gun, point the Spray Gun into a waste pail and pull the Trigger for 10 seconds or until there is a steady stream of paint. This will purge air (and storage fluid) from the Hose and Gun.

NOTE:

If the sprayer does not spray after 10 seconds, STOP and repeat STARTUP. Continuing to trigger the gun without spraying material may damage the pump.

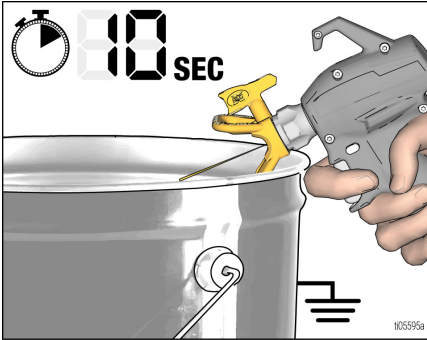

8. Turn the Spray Tip forward to SPRAY position.
You are now ready to spray.

OPERATION

The instructions provide guidance on how to use the QuickShot™ II.

PRESSURE RELIEF PROCEDURE

Relieve pressure on the QuickShot II when operation is stopped, and before cleaning, checking, or servicing the equipment.



Follow the Pressure Relief Procedure whenever you see this symbol.

! WARNING			
<p>This equipment stays pressurized until pressure is manually relieved. To help prevent serious injury from pressurized fluid, such as skin injection, and splashing fluid, follow the Pressure Relief Procedure when you stop spraying and before cleaning, checking, or servicing the equipment.</p>			

1. Turn the Prime Knob up to the PRIME position to relieve system pressure.

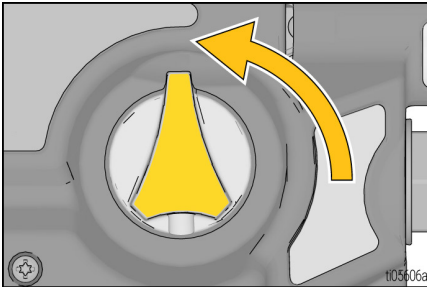

2. Hold metal tip guard nut firmly to a grounded metal pail. Point Spray Gun into pail, disengage Trigger Lock, and trigger the Spray Gun to relieve system pressure.

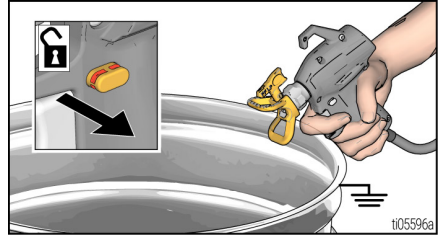

NOTE:

Leave Prime Knob in the PRIME position until you are ready to spray.

PREPARE TO SPRAY

Take a few moments prior to spraying and review these simple tips to ensure your spraying project is a success.

! WARNING			

NOTE:

For proper spraying operation use only Graco FFLP family of tips with your Spray Gun.

If spraying with **oil-based or flammable** materials, follow **Grounding Instructions**.

OPERATION

ADJUST FLOW CONTROL

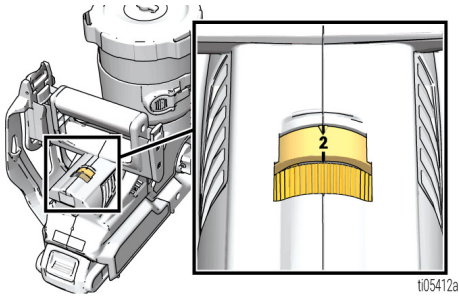

The Flow Control allows for precise pressure adjustment. To reduce overspray, always start at lowest speed setting and increase speed to the minimum setting that results in an acceptable spray pattern.

SELECT TIP AND PRESSURE

See table for general recommendations for Spray Tip sizes and Flow Control settings for materials. Also refer to paint (material) can for manufacturer's recommendations.

TIP HOLE SIZE	MATERIAL AND FLOW CONTROL SELECTION					
	INTERIOR STAINS/ INTERIOR & EXTERIOR CLEARS	EXTERIOR SOLID STAINS	ENAMELS	PRIMERS	INTERIOR LATEX PAINTS	EXTERIOR LATEX PAINTS
	1 - 4	4 - 8	4 - 10	6 - 10	6 - 10	6 - 10
0.008 in. (0.20 mm)	✓	✓	✓			
0.010 in. (0.25 mm)	✓	✓	✓			
0.012 in. (0.30 mm)	✓	✓	✓			
0.014 in. (0.36 mm)		✓	✓	✓	✓	✓
0.016 in. (0.41 mm)			✓	✓	✓	✓

ADJUST SPRAY TIP

WARNING				
				
<p>To avoid serious injury from skin injection, do not put your hand in front of the Spray Tip or Spray Tip Guard.</p>				

1. Engage the Trigger Lock.

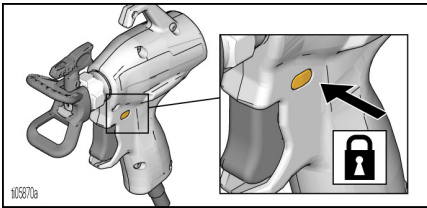

2. Adjust the Spray Tip Guard for the desired vertical or horizontal spraying direction.

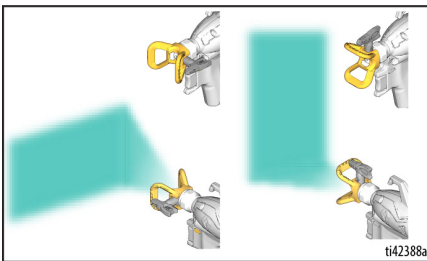

PRACTICE SPRAY TECHNIQUES

Use a piece of scrap cardboard to practice these basic spraying techniques before you begin spraying the surface.

- Hold Spray Gun 12 in. (30 cm) from surface and aim straight at surface. Tilting the Spray Gun to direct the spray at an angle causes an uneven finish.
- Flex wrist to keep Spray Gun pointed straight. Fanning the Spray Gun to direct spray at an angle causes an uneven finish.

NOTE:

How fast you move the spray gun will affect spray performance. If material is uneven, you are moving the gun too fast. If material drips, you are moving the gun too slowly. See **Troubleshooting**.

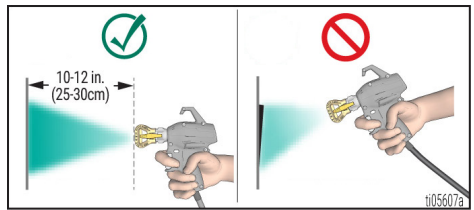

AIM THE SPRAY GUN

Aim the Spray Gun at the bottom edge of the previous stroke, overlapping each stroke by 50 percent.

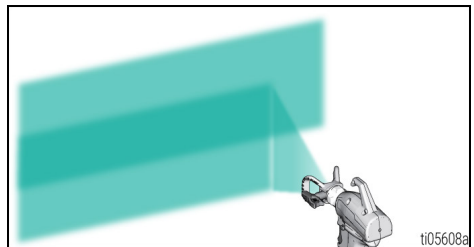

TRIGGER GUN AFTER STARTING STROKE

Pull Trigger after starting stroke. Release Trigger before end of stroke. Spray Gun must be moving when Trigger is pulled and released.

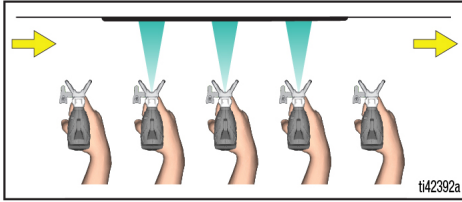

TEST SPRAY PATTERN QUALITY

A good spray pattern is evenly distributed as it hits the surface.

- Spray should be atomized (evenly distributed, no gaps at edges).

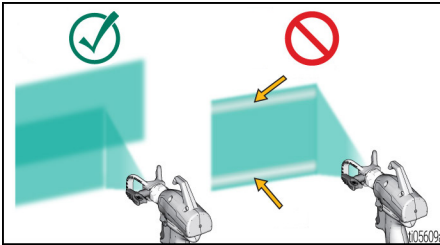

If tails persist when spraying at the highest spray pressure:

- Spray Tip may be worn. See **Tip and Pressure Selection**.
- A smaller Spray Tip may be needed.
- Material may need to be thinned. Follow manufacturer's recommendations.

CLEAR TIP CLOG

 WARNING			
			
<p>To avoid serious injury from skin injection, do not put your hand in front of the Spray Tip or Spray Tip Guard.</p>			

1. Release Trigger. Engage Trigger Lock. Rotate Spray Tip to UNCLOG position. Disengage Trigger Lock. Trigger Spray Gun into waste pail to clear clog.

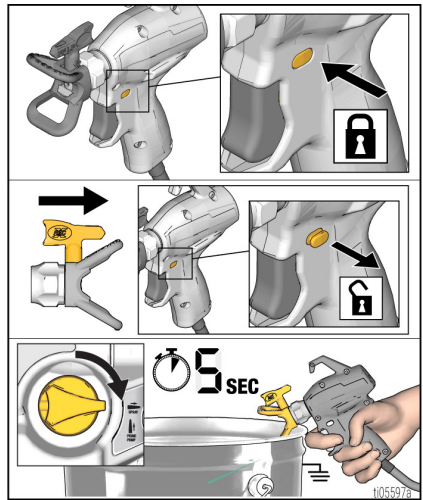



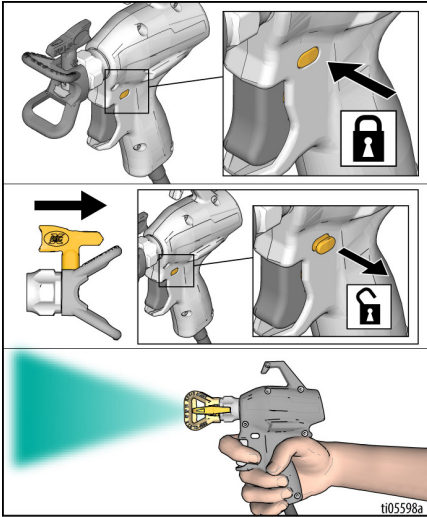

- Engage Trigger Lock. Return Spray Tip to SPRAY position. Disengage Trigger Lock and continue spraying.



NOTE:

If Spray Tip is still clogged, repeat steps 1 and 2 with Flow Control set to 10. If this does not unclog the Spray Tip, you may have to replace the tip.

REFILL CUP

 WARNING			
			
<p>Flammable fumes (such as solvent and paint fumes) in work area can ignite or explode.</p> <p>See Grounding Instructions.</p> <p>Do not spray flammable or combustible liquids in a confined area. When spraying flammable or combustible materials:</p> <ul style="list-style-type: none"> Move entire sprayer to a well-ventilated area and away from flammable or combustible materials, including paints and solvents when refilling. Keep material containers covered between cup refills. 			

Cup refills can be performed while wearing the sprayer on the Belt or after removing the sprayer from the Belt and setting the sprayer on a flat surface.

- Engage Trigger Lock. Turn the Prime Knob up to PRIME position to relieve system pressure.

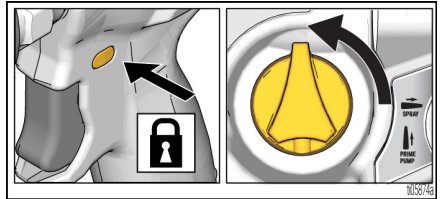

OPERATION

2. If desired, remove sprayer from the Belt by pressing the Holster Release Clip and pulling up on the sprayer.

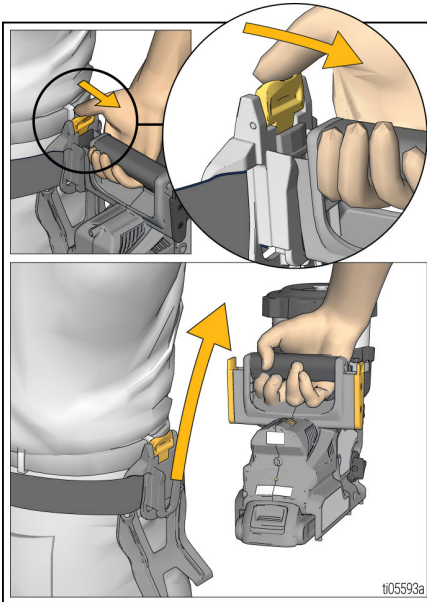

3. Remove the Cup Lid from the Cup.

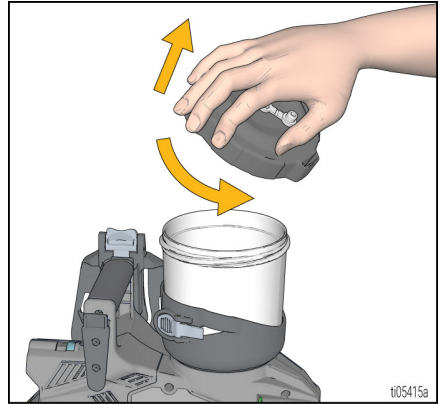

NOTE:

You can hook the Cup Lid onto the sprayer while you refill the Cup.

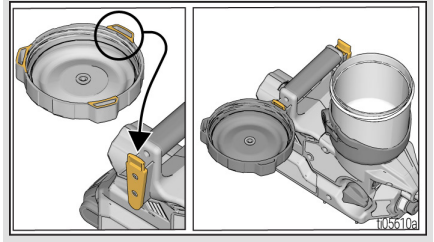

4. Remove the Cup Strainer and clean debris from the filter screen.

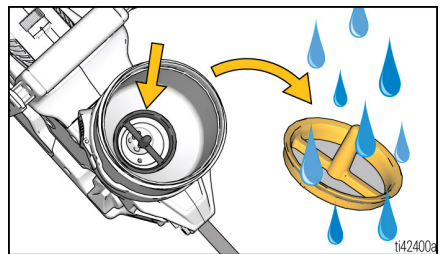

NOTE:

For easiest filter removal, pull filter post (1) towards the rib (2) of the filter.

OPERATION

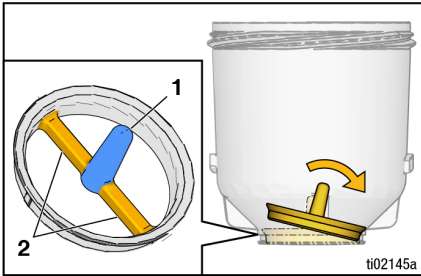

5. Reinstall Cup Strainer in the bottom of the Cup.

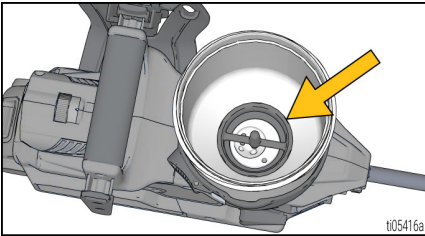

6. Refill the Cup with paint and reinstall Cup Lid.

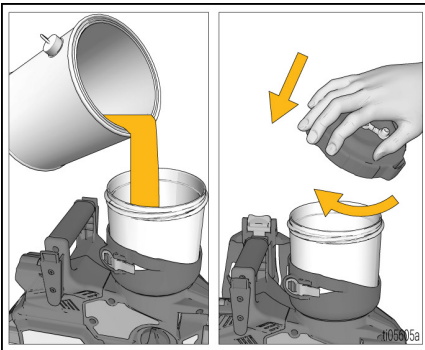

7. Follow **Startup** to proceed.

PREVENT CLOGS DURING PAUSE

Paint will dry quickly and cause clogs in the sprayer. Follow these steps whenever you pause spraying for 5 minutes to 2 hours.

1. Engage Trigger Lock and remove Battery from sprayer.
2. Turn Prime Knob up to PRIME position to relieve system pressure.

3. Turn Spray Tip 90 degrees to seal orifice from drying out.

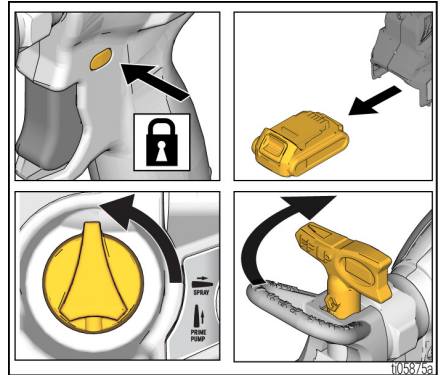

4. Close Storage Plug in Cup Lid to seal material in Cup.

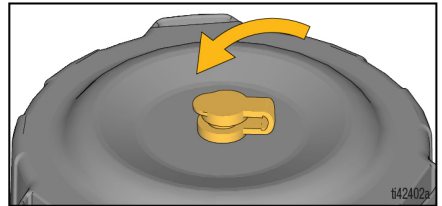

CLEANUP

Properly cleaning the QuickShot™ II after each use and before storage will ensure proper operation.

NOTICE

Failure to properly clean sprayer after each use will result in hardened materials, damage to the sprayer, and the warranty will no longer be valid. Do not store solvents other than mineral spirits in sprayer. Always flush with Graco Pump Armor™ prior to storage.

WARNING



To avoid serious injury from fire and explosion when using oil-based or flammable materials:

- Clean in a well-ventilated area. Keep a good supply of fresh air moving through the area.
- When flushing with solvents, always ground the sprayer and waste container.

See **Cleaning Fluid Compatibility** and **Grounding Instructions** for additional information when using oil-based or flammable materials.

CLEAN THE SPRAYER

WARNING



To help prevent serious injury from pressurized fluid, such as skin injection or splashing fluid, do not immerse gun in solvent. Perform the **Pressure Relief Procedure** before cleaning, checking, or servicing the equipment.

1. Engage Trigger Lock.

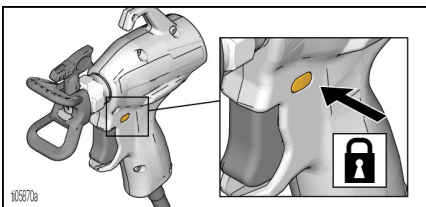

2. Turn Prime Knob up to PRIME position to relieve system pressure.

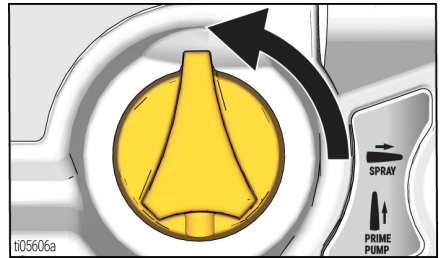

3. Remove sprayer from the Belt by pressing the Holster Release Clip and pulling up on the sprayer.

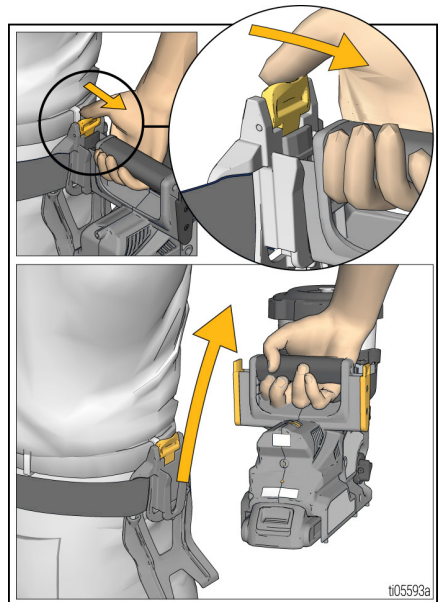

CLEANUP

- Remove Cup Lid and pour extra paint back into paint can.

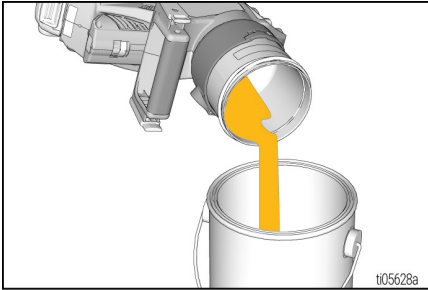

NOTE:

Always clean sprayer with a clean Cup Strainer installed to prevent debris from lodging in the pump or Spray Gun.

- Verify Cup is empty and remove cup from sprayer by depressing the Cup Release Lever and rotating Cup out of the Cup Support.

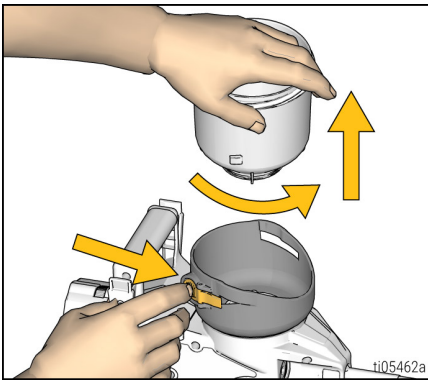

- Clean Cup, Cup Lid, and Cup Strainer in warm water.
- Wipe out Cup Support with wet rag. Reinstall Cup and Cup Strainer back into the Cup Support.

- Fill Cup with cleaning fluid, see **Cleaning Fluid Compatibility**, and reinstall Cup Lid. Verify Storage Plug is in the OPEN position.

- Verify the Prime Knob is pointed up in the PRIME position. Remove the Tip Guard and Spray Tip.

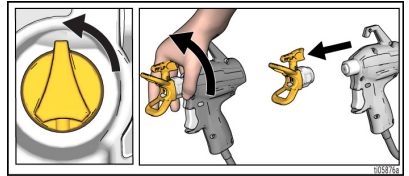

- Disengage the Trigger Lock and turn the Flow Control to Quick Flush.

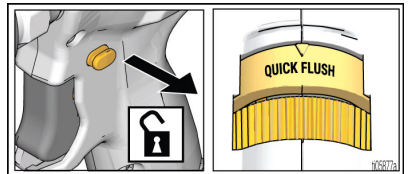

- Hold the metal tip guard threads firmly to a grounded metal pail. Point Spray Gun into waste pail and pull and hold trigger for 15 seconds.

NOTE:

The sprayer will run through stage 1 of the cleaning process.

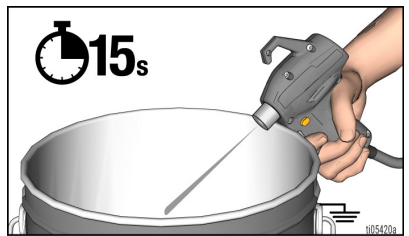

- Turn the Prime Knob forward to the **SPRAY** position. Point the Spray Gun into waste pail and trigger the gun until the Cup is empty.

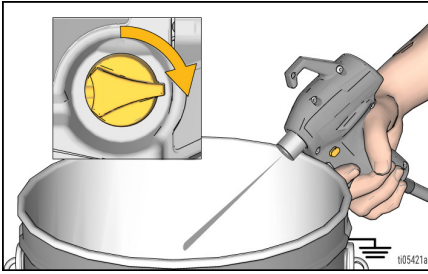

- Repeat steps 8 and 9 as needed until the Sprayer is clean.
- Clean the static wicks on the sprayer and on the Spray Gun.

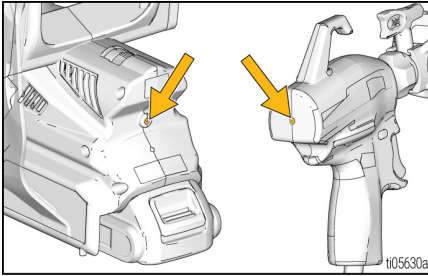

- Clean the filter. See **Clean the Filter**.
- Clean Spray Tip and Spray Tip Guard in a bucket of compatible cleaning solution. Reinstall Spray Tip and Spray Tip Guard.
- Before storage, circulate and spray a small amount of Pump Armor.
- Engage Trigger Lock. Turn Prime Knob up to **PRIME** position.

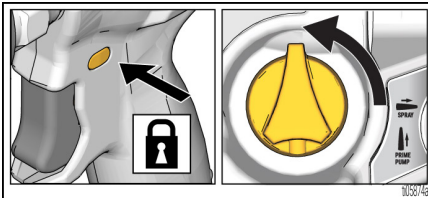

- Turn Spray Tip 90 degrees for storage and close Storage Plug on Cup Lid.

CLEAN THE FILTER

- Turn the Prime Knob to **PRIME** position. Remove the Pump Filter from the Pump and clean the debris from the filter screen.

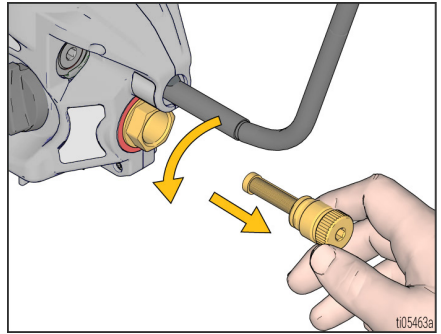

NOTE:

Pull the filter from the Pump Filter Cap to flush properly.

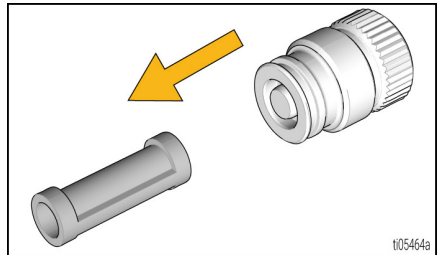

- Once clean, reinstall the Pump Filter into the Pump Filter Cap.

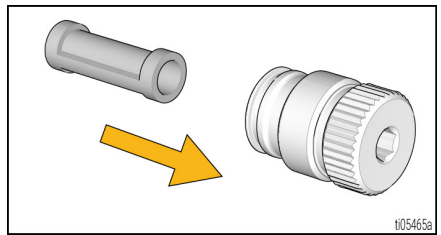

PREPARE SPRAYER FOR STORAGE

NOTICE

Failure to store sprayer with Pump Armor can result in operational problems the next time you spray. Always circulate Pump Armor through the sprayer after cleaning. **Water or solvents other than mineral spirits left in the sprayer will corrode and damage the pump.**

Pump Armor fluid protects the sprayer while in storage. It helps protect sprayer against startup issues on next use.

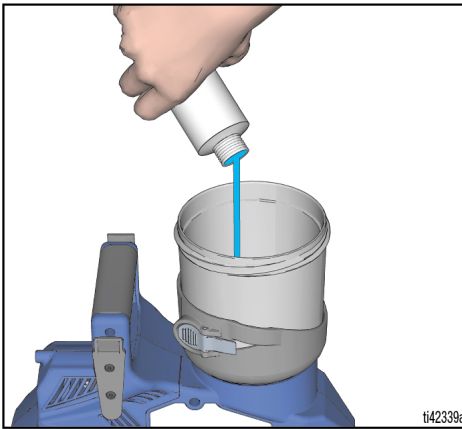

ti42339a

- Circulate and spray a small amount of Pump Armor Storage Fluid.
- Engage Trigger Lock
- Turn Prime Knob to PRIME position.
- Remove Battery, Spray Tip, and Spray Tip Guard.
- Clean Spray Tip and Spray Tip Guard with warm water and an old tooth brush, and reinstall onto gun.
- Turn Spray Tip 90 degrees for storage, and close Storage Plug on Cup Lid.
- Do not store the sprayer full of water.
- Do not allow water to freeze in sprayer.
- Do not store sprayer under pressure.
- Store sprayer indoors in a cool, dry location.
- Never store sprayer with material in the sprayer or Cup.

RECYCLING AND DISPOSAL

Properly recycle and dispose of the QuickShot II at the end of its useful life.

RECHARGEABLE BATTERY DISPOSAL

Do not place batteries in the trash. Recycle batteries according to local regulations. In the USA and Canada, call 1-800-822-8837 to find recycling locations or go to www.call2recycle.org.

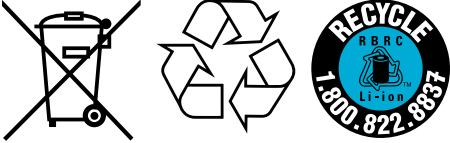

END OF PRODUCT LIFE

At the end of a product's useful life, recycle it in a responsible manner.

TROUBLESHOOTING

When problems occur, use the table to identify potential causes and solutions to repair the QuickShot™ II.



Follow **Pressure Relief Procedure** before checking or repairing the equipment.

NOTE:

Check all possible problems and causes before disassembling the equipment.



TROUBLESHOOTING

PROBLEM	CAUSE	SOLUTION
Sprayer makes no sound when trigger is pulled.	Diagnostic light blinks two times when trigger is pulled. Indicates incorrect voltage.	Replace battery with a charged battery. Battery has reached end of life. Replace battery.
	Diagnostic light blinks three times when trigger is pulled. Indicates battery temperature is too hot or cold.	Allow battery to cool down or warm up to room temperature.
	Diagnostic light blinks four times when trigger is pulled. Indicates locked rotor condition.	Replace pump and/or motor assembly.
	Electronic hose connections are not connected.	Ensure electronic wire connectors are tight at both ends of the hose inside the sprayer and gun ProConnect access doors.
	Hose wires are damaged.	Replace hose.
	Battery or SmartControl issue.	Install battery or replace battery. Replace SmartControl.
Sprayer makes sound but no material is sprayed when trigger is pulled.	Sprayer is not primed.	Repeat Startup .
	No air allowed into cup.	Make certain the storage plug on the cup lid is open when spraying.
	Debris in paint, dirty cup strainer.	Clean sprayer. See Cleanup . Strain paint before filling cup and repeat Setup and Startup .
	Prime Knob is in PRIME position.	Turn Prime Knob forward to SPRAY position.
	Spray Tip is not in SPRAY position.	Turn Spray Tip to SPRAY position.
	Spray Tip is clogged.	Clear clog. See Clear Tip Clogs .
	No or low material in Cup.	Refill Cup with paint. See Refill Cup .
	Debris stuck in Spray Gun or Pump.	Clear clog. See Clear Tip Clogs .

TROUBLESHOOTING

PROBLEM	CAUSE	SOLUTION
	Cartridge is not fully bottomed out.	Remove PowerShot ProConnect Cartridge from Spray Gun. Clean gun passage and Cartridge so there is no debris and parts are clean. Reassemble. Bottom out Cartridge and torque to 100 in-lbs.(11.3 N·M).
	Cartridge is at end of life.	Replace cartridge.
	Pump has reached the end of its life.	Replace pump assembly.
	Hose is plugged.	Replace hose.
	Hose wires are damaged.	Replace hose.
	Spray Gun has reached end of life.	Replace Spray Gun.
Sprayer sprays with poor results.	Flow control is set too low.	Increase speed until an acceptable pattern is achieved.
	No air allowed into Cup.	Make certain the Storage Plug on the Cup Lid is open when spraying.
	Spray Tip is partially clogged.	Clear clog. See Clear Tips Clogs .
	Spray Tip is not in correct position.	Rotate Spray Tip to SPRAY position.
	Incorrect Spray Tip for application of material.	Install different size Spray Tip, see Select Tip and Pressure .
	Spray Tip is worn or damaged.	Replace Spray Tip, see Spray Tip Installation and Removal .
	Depleted battery.	Recharge or replace battery.
	Material being sprayed is aerated because it was shaken.	DO NOT shake material. Stir the material or check the manufacturer's recommendation for the material being sprayed.
	Material being sprayed is too cold to spray.	Warm material.
	Material being sprayed is incompatible with sprayer.	Fully clean system. See Cleanup . Try thinning the material per manufacturer's recommendation, or switch to a different material.

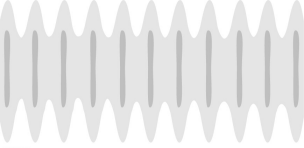
TROUBLESHOOTING

PROBLEM	CAUSE	SOLUTION
	Gasket on front of Spray Gun is damaged or lost.	Replace gasket.
	Debris stuck in Spray Gun or Pump.	Clear clog. See Clear Tip Clogs .
	Hose wires are damaged.	Replace hose.
	Spray Gun has reached end of life.	Replace Spray Gun.
	Pump has reached end of life.	Replace pump assembly.
Sprayer will spray paint, but will not spray water.	Prime valve leaking.	Replace prime valve.
	Battery has insufficient charge.	Charge battery.
	Pump has reached the end of its life.	Replace pump assembly.
Spray pattern is uneven:  <small>t15524b</small>	Operator is moving too fast while spraying.	Slow speed of movement.
	Spray Tip is clogged.	Unclog Spray Tip or clean Spray Tip. See Clear Tip Clogs .
	Material difficult to atomize.	Increase speed until desired pattern is achieved.
		Hold sprayer farther away from surface. Switch to different Spray Tip, see Select Tip and Pressure .
Outlet plugs are dirty or worn.	Remove two outlet plugs and filter housing to gain access to the three outlet valves. Clean outlet plugs and filter housing. Replace if necessary.	
Spray pattern has tails:  <small>t15526b</small>	Speed control is set too low.	Increase speed until desired pattern is achieved.
	Incorrect Spray Tip for application of material.	Install different size Spray Tip. See Select Tip and Pressure .
	Material may need to be thinned.	Thin material follow paint manufacturer's recommendations.

TROUBLESHOOTING

PROBLEM	CAUSE	SOLUTION
	Spray Tip is worn or damaged.	Replace Spray Tip, see Spray Tip Installation and Removal .
	Material may not be compatible with sprayer.	Switch material.
Spray pattern has dipping/sagging:	Operator is moving too slowly while spraying.	Move faster while spraying.
	Sprayer is too close to target surface.	Move sprayer away from surface 10 in. (25 cm).
	Holding trigger while changing spray direction.	Release trigger when changing directions.
	Speed control is set too high.	Decrease speed until desired pattern is achieved.
	Spray Tip is worn or damaged.	Replace Spray Tip. See Spray Tip Installation and Removal .
Spray pattern is too narrow.	Sprayer is too close to target surface.	Move sprayer away from surface 10 in. (25 cm).
	Incorrect Spray Tip for application of material.	Install different size Spray Tip. See Select Tip and Pressure .
	Spray Tip is damaged or worn.	Replace Spray Tip. See Spray Tip Installation and Removal .
Spray pattern is too wide.	Sprayer is too far away from target surface.	Move sprayer closer to surface.
	Incorrect spray tip for application of material.	Install different size Spray Tip. See Spray Tip Installation and Removal .
Spray pattern spits at the beginning or end of pattern:	Excess material has accumulated on Spray Tip guard assembly or Spray Tip is partially clogged.	Clear Spray Tip Guard. See Clear Tip Clogs .
	Spray Tip not inserted completely into Spray Tip Guard.	Insert spray tip properly. See Spray Tip Installation and Removal .
	Spray Tip is worn.	Replace Spray Tip. See Spray Tip Installation and Removal .
	Sprayer is dirty.	Flush sprayer.

TROUBLESHOOTING

PROBLEM	CAUSE	SOLUTION
	Filter housing has reached the end of its life.	Replace filter housing assembly.
Spray Tip continues to drip or ooze material after trigger is released.	Spray Tip is worn.	Replace Spray Tip. See Spray Tip Installation and Removal .
	Spray Tip not inserted completely into Spray Tip Guard.	Install Spray Tip properly. See Spray Tip Installation and Removal .
Material leaks around Spray Tip Guard or Spray Tip Handle.	Spray Tip seal and seat are damaged or not properly installed.	Install Spray Tip properly, or replace Spray Tip. See Spray Tip Installation and Removal .
Gun will only spray a quick pulse and not stay open.	Battery issue.	Install battery or replace battery.
	Cartridge is not fully bottomed out.	Remove PowerShot Pro Connect Cartridge from Spray Gun. Clean gun passage and Cartridge so there is no debris and parts are clean. Reassemble. Bottom out Cartridge and torque to 100 in-lbs. (11.3 N·M).
Gun will spray at low pressure but not high pressure.	PowerShot ProConnect Cartridge is at end of life.	Replace cartridge.
Speed does not adjust at the top of the range, or, speed seems to "dip" at the top of the range.	The sprayer has reached the maximum performance in the selected media and tip.	This is normal. No damage will occur when running in this condition. If application speed is too slow at the selected flow control position, select a larger tip.

REPLACEMENT PARTS

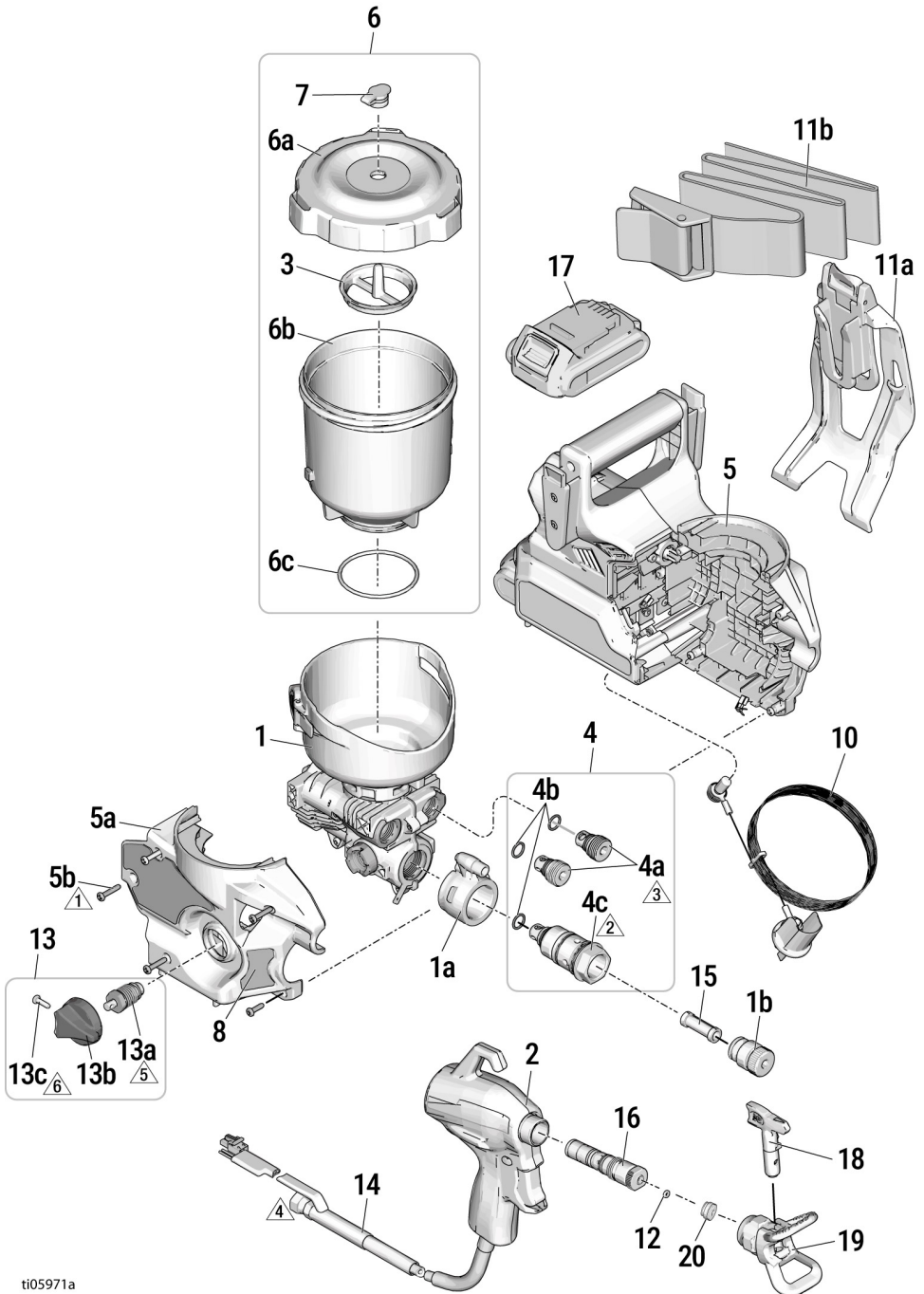

ti05971a

Figure 16-1: QuickShot™ II Parts Diagram

REPLACEMENT PARTS

PARTS LIST

REF.	PART NO.	DESCRIPTION
1	2014551	KIT, pump assembly, filtered, QuickShot II, <i>includes 4, 13, 15</i>
1a		HOUSING, outlet
1b		CAP, filter
2	2014779	KIT, applicator, replacement, QuickShot II, <i>includes 12, 14, 16</i>
3	18H073	KIT, filter, 20 mesh, 3 PK, QuickShot
4	2014548	KIT, outlet valve, QuickShot II, <i>includes 1b, 15</i>
4a		OUTLET PLUGS, <i>includes o-rings</i>
4b		PACKING, o-ring
4c		FILTER HOUSING, <i>includes o-rings</i>
5	2014547	KIT, control, enclosures, QuickShot II, <i>includes 8</i>
5a*		MODULE, motor control, outer router
5b		SCREW, cross-head
6	18H079	KIT, cup, lid, plug, o-ring, label, <i>includes 3, 7</i>
6a		CUP, lid
6b		CUP, 32 oz
6c		O-RING
7	18H080	KIT, plug, 3 pc, QuickShot
8	2014549	KIT, label, brand, Ultra, QuickShot II
8a**	2014550	KIT, label, brand, Ultimate, QuickShot II

REF.	PART NO.	DESCRIPTION
9▲*	2014551	KIT, warning, labels, QuickShot II
10	18H085	KIT, ground, QuickShot
11	18H086	KIT, belt, holster, QuickShot
11a		HOLSTER
11b		BELT
12	18H126	KIT, solvent, gasket, with removal tool
13	2000079	KIT, replacement, prime valve, knob, QuickShot
13a		PRIME VALVE
13b		PRIME KNOB
13c		SCREW, cross head
14	2014917	KIT, hose, QuickShot
15	2014138	KIT, filter, pump, paint/stain, 2014600 (60 mesh) paint/ 2014121 (100 mesh) stain
16	2005788	KIT, cartridge, replacement
17*		Li-ion battery pack, DEWALT
	17P474	20 V, 2.0 A - USA
	17P557	18 V, 2.0 A - Europe/AP
	17P556	18 V, 2.0 A - Japan
	17P558	18 V, 2.0 A - ANZ
	17P586	18 V, 2.0 A - Korea
*		Li-ion Compact Battery Charger, DEWALT (not shown)
	17P475	120 V - USA
	17P560	230 V - Europe/AP
	17P559	100 V - Japan
	17P561	230 V - ANZ

REPLACEMENT PARTS

REF.	PART NO.	DESCRIPTION
	17P587	230 V - Korea
18	FFLP514	SPRAY TIP
	FFLP210	SPRAY TIP
19		GUARD, spray tip, FFLP
20		TIP, seal and seat
<p>* Battery and charger depend on in-country requirements.</p> <p>** Kits not shown on parts diagram.</p> <p>▲ Replacement safety labels, tags, and cards are available at no cost.</p>		

NOTE:

Gun 18H059 and Hose 2000354 are designed for use with the QuickShot sprayer only.

Table 16-1: References

① 18 +/- 5 in-lb (0.6 +/- N·m)

④ 95-105 in-lb (10.7-11.9 N·m)

② 85-95 in-lb (9.6-10.7 N·m)

⑤ 10-15 in-lb (1.1-1.7 N·m)

③ 20 +/- 0.8 in-lb (2.3 +/- 0.1 N·m)

⑥ 9-11 in-lb (1-1.2 N·m)

CALIFORNIA PROPOSITION 65

CALIFORNIA RESIDENTS



WARNING Cancer and reproductive harm – www.P65warnings.ca.gov.

GRACO STANDARD WARRANTY

Graco warrants all equipment referenced in this document which is manufactured by Graco and bearing its name to be free from defects in material and workmanship on the date of sale to the original purchaser for use. With the exception of any special, extended, or limited warranty published by Graco, Graco will, for a period of twelve months from the date of sale, repair or replace any part of the equipment determined by Graco to be defective. This warranty applies only when the equipment is installed, operated and maintained in accordance with Graco's written recommendations.

This warranty does not cover, and Graco shall not be liable for general wear and tear, or any malfunction, damage or wear caused by faulty installation, misapplication, abrasion, corrosion, inadequate or improper maintenance, negligence, accident, tampering, or substitution of non-Graco component parts. Nor shall Graco be liable for malfunction, damage or wear caused by the incompatibility of Graco equipment with structures, accessories, equipment or materials not supplied by Graco, or the improper design, manufacture, installation, operation or maintenance of structures, accessories, equipment or materials not supplied by Graco.

This warranty is conditioned upon the prepaid return of the equipment claimed to be defective to an authorized Graco distributor for verification of the claimed defect. If the claimed defect is verified, Graco will repair or replace free of charge any defective parts. The equipment will be returned to the original purchaser transportation prepaid. If inspection of the equipment does not disclose any defect in material or workmanship, repairs will be made at a reasonable charge, which charges may include the costs of parts, labor, and transportation.

THIS WARRANTY IS EXCLUSIVE, AND IS IN LIEU OF ANY OTHER WARRANTIES, EXPRESS OR IMPLIED, INCLUDING BUT NOT LIMITED TO WARRANTY OF MERCHANTABILITY OR WARRANTY OF FITNESS FOR A PARTICULAR PURPOSE. Graco's sole obligation and buyer's sole remedy for any breach of warranty shall be as set forth above. The buyer agrees that no other remedy (including, but not limited to, incidental or consequential damages for lost profits, lost sales, injury to person or property, or any other incidental or consequential loss) shall be available. Any action for breach of warranty must be brought within two (2) years of the date of sale.

GRACO MAKES NO WARRANTY, AND DISCLAIMS ALL IMPLIED WARRANTIES OF MERCHANTABILITY AND FITNESS FOR A PARTICULAR PURPOSE, IN CONNECTION WITH ACCESSORIES, EQUIPMENT, MATERIALS OR COMPONENTS SOLD BUT NOT MANUFACTURED BY GRACO. These items sold, but not manufactured by Graco (such as electric motors, switches, hose, etc.), are subject to the warranty, if any, of their manufacturer. Graco will provide purchaser with reasonable assistance in making any claim for breach of these warranties.

In no event will Graco be liable for indirect, incidental, special or consequential damages resulting from Graco supplying equipment hereunder, or the furnishing, performance, or use of any products or other goods sold hereto, whether due to a breach of contract, breach of warranty, the negligence of Graco, or otherwise.

FOR GRACO CANADA CUSTOMERS The Parties acknowledge that they have required that the present document, as well as all documents, notices and legal proceedings entered into, given or instituted pursuant hereto or relating directly or indirectly hereto, be drawn up in English. Les parties reconnaissent avoir convenu que la rédaction du présente document sera en Anglais, ainsi que tous documents, avis et procédures judiciaires exécutés, donnés ou intentés, à la suite de ou en rapport, directement ou indirectement, avec les procédures concernées.

GRACO INC. AND SUBSIDIARIES | P.O. BOX 1441 | MINNEAPOLIS MN 55440-1441 | USA

Graco Headquarters: Minneapolis, MN USA | International Offices: Australia, Belgium, China, Japan, Korea | Toll Free Phone Number: 1-800-690-2894 (Contractor Division) and 1-800-328-0211 (Industrial Division) | For patent information, see graco.com/patents

©2026 Graco Inc. All written and visual data in this document are based on the latest product information available at the time of publication. Graco reserves the right to make changes at any time without notice. All Graco manufacturing locations maintain ISO 9001:2015 certifications, each certified by accredited certification bodies. Original Instructions. This manual contains English. Revision B, March 2026