

# ProReach™ Telescoping Spray Pole

Extension pole kit for airless spray guns for spraying high-reach areas. For professional use only.



## Important Safety Instructions

Read all warnings and instructions in this manual before using the equipment. Be familiar with the proper control and usage of the equipment. Refer to your sprayer instruction manual for Pressure Relief, prime, and spray instructions. Save these instructions.



## Important Medical Information

Read the medical alert card provided with the gun. It contains injection injury treatment information for a doctor. Keep it with you when operating the equipment.



[graco.com/contact](https://graco.com/contact)

# CONTENTS

---

<b>Models</b>	<b>3</b>
<b>Translated Manuals</b>	<b>3</b>
<b>Technical Specifications</b>	<b>3</b>
<b>Safety Symbols</b>	<b>4</b>
<b>Warnings</b>	<b>5</b>
<b>Component Identification</b>	<b>8</b>
<b>Setup</b>	<b>9</b>
<b>Install Spray Gun</b>	<b>9</b>
<b>Operation</b>	<b>11</b>
<b>Operate the ProReach™ Telescoping Pole</b>	<b>11</b>
<b>Remove Spray Gun from Pole</b>	<b>12</b>
<b>Maintenance</b>	<b>13</b>
<b>End of Product Life</b>	<b>13</b>
California Proposition 65	13
<b>Troubleshooting</b>	<b>14</b>
<b>Repair</b>	<b>16</b>
<b>ProReach™ Telescoping Spray Pole Parts</b>	<b>18</b>

## MODELS

The part numbers reflect distinct features and characteristics of the ProReach™ Telescoping Spray Pole.

### MODELS AND APPROVALS

MODEL	DESCRIPTION
2014939	ProReach Telescoping Spray Pole

### TRANSLATED MANUALS

Translations for the ProReach™ Telescoping Spray Pole are available at [www.graco.com](http://www.graco.com) by searching for manual number X055732.

The following translations are available: Bulgarian, Chinese, Croatian, Czech, Danish, Dutch, English, Estonian, Finnish, French, German, Greek, Hungarian, Italian, Japanese, Korean, Latvian, Lithuanian, Norwegian, Polish, Portuguese, Romanian, Slovakian, Slovenian, Spanish, Swedish, Turkish.

### TECHNICAL SPECIFICATIONS

The table provides important information related to the ProReach™ Telescoping Spray Pole, including product attributes, measurements, and performance characteristics that support the use of the equipment.



Table 1-1: Technical Specifications for ProReach™ Telescoping Spray Pole

	US	METRIC
Retracted length	5 ft	1.52 m
Extended length	12 ft	3.66 m
Compacted length	4.5 ft	1.37 m
Weight	3.75 lb	1.7 kg
Maximum gun fluid working pressure	3600 psi (248 bar, 24.8 MPa)	
<b>Notes</b>		
All trademarks or registered trademarks are the property of their respective owners.		

# SAFETY SYMBOLS

The following safety symbols appear throughout this manual and on warning labels. Read the table to understand what each symbol means.

SYMBOL	MEANING
	Electrocution Hazard
	Equipment Misuse Hazard
	Fire and Explosion Hazard
	Gun Recoil Hazard
	Skin Injection Hazard
	Skin Injection Hazard
	Splash Hazard
	Do Not Place Hands or Other Body Parts Near Fluid Outlet

SYMBOL	MEANING
	Do Not Stop Leaks with Hand, Body, Glove or Rag
	Eliminate Ignition Sources
	Follow Pressure Relief Procedure
	Ground Equipment
	Read Manual
	Ventilate Work Area
	Wear Personal Protective Equipment



## Safety Alert Symbol

This symbol indicates: Attention! Become Alert! Look for this symbol throughout the manual to indicate important safety messages.

## WARNINGS

---

The following warnings apply throughout this manual. Read, understand, and follow the warnings before using this equipment. Failure to follow these warnings can result in serious injury.



**DANGER**



**ELECTROCUTION HAZARD**

To avoid death or serious injury, avoid contact with power lines.

 **WARNING**



**SKIN INJECTION HAZARD**

High-pressure fluid from gun, hose leaks, or ruptured components will pierce skin. This may look like just a cut, but it is a serious injury that can result in amputation. **Get immediate surgical treatment.**



- Do not spray without tip guard and trigger guard installed.
- Engage trigger lock when not spraying.
- Do not point gun at anyone or at any part of the body.
- Do not put your hand over the spray tip.
- Do not stop or deflect leaks with your hand, body, glove, or rag.
- Follow the **Pressure Relief Procedure** when you stop spraying and before cleaning, checking, or servicing equipment.
- Tighten all fluid connections before operating the equipment.
- Check hoses and couplings daily. Replace worn or damaged parts immediately.



**RECOIL HAZARD**

Gun may recoil when triggered. If you are not standing securely, you could fall and be seriously injured.



**FIRE AND EXPLOSION HAZARD**

Flammable fumes, such as solvent and paint fumes, **in work area** can ignite or explode. Paint or solvent flowing through the equipment can cause static sparking. To help prevent fire and explosion:



- Use equipment only in well-ventilated area.
- Eliminate all ignition sources, such as pilot lights, cigarettes, portable electric lamps, and plastic drop cloths (potential static sparking).
- Ground all equipment in the work area. See **Grounding** instructions.
- Never spray or flush solvent at high pressure.
- Keep work area free of debris, including solvent, rags and gasoline.
- Do not plug or unplug power cords, or turn power or light switches on or off when flammable fumes are present.
- Use only conductive and grounded hoses.
- Hold gun firmly to side of grounded pail when triggering into pail. Do not use pail liners unless they are anti-static or conductive.
- **Stop operation immediately** if static sparking occurs or you feel a shock. Do not use equipment until you identify and correct the problem.
- Keep a working fire extinguisher in the work area.



## WARNING



### EQUIPMENT MISUSE HAZARD

Misuse can cause death or serious injury.

- Always wear appropriate gloves, eye protection, and a respirator or mask when painting.
- Do not operate or spray near children. Keep children away from equipment at all times.
- Do not overreach or stand on an unstable support. Keep effective footing and balance at all times.
- Stay alert and watch what you are doing.
- Do not operate the unit when fatigued or under the influence of drugs or alcohol.
- Do not kink or overbend the hose.
- Route hoses, fluid lines, cords, and cables away from traffic areas, sharp edges, moving parts, and hot surfaces.
- Do not expose the hose to temperatures or to pressures in excess of those specified by Graco.
- Do not use the hose as a strength member to pull or lift the equipment.
- Do not spray with a hose shorter than 25 feet (7.6 m).
- Do not alter or modify equipment. Alterations or modifications may void agency approvals and create safety hazards.
- Make sure all equipment is rated and approved for the environment in which you are using it.



### PERSONAL PROTECTIVE EQUIPMENT

Wear appropriate protective equipment when in the work area to help prevent serious injury, including eye injury, hearing loss, inhalation of toxic fumes, and burns. Protective equipment includes but is not limited to:

- Protective eyewear and hearing protection.
- Respirators, protective clothing, and gloves as recommended by the fluid and solvent manufacturer.

# COMPONENT IDENTIFICATION

The diagram highlights the controls and features on the ProReach™ Telescoping Spray Pole that are used during typical operation.

## PROREACH TELESCOPING SPRAY POLE

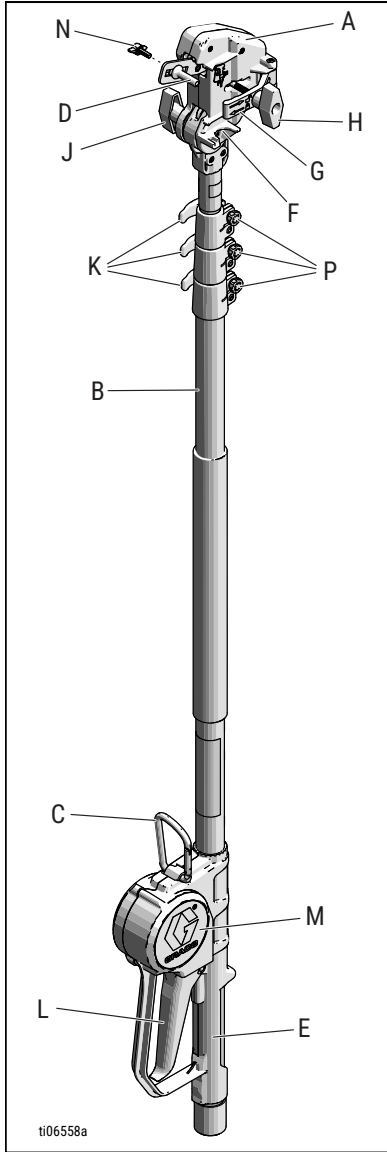

### KEY

- A Gun Holder
- B Telescoping Pole
- C Hose Carabiner
- D Gun Trigger Actuator
- E Handle
- F Gun Swivel Holder
- G Gun Clamp Arm
- H Gun Clamp Knob
- J Angle Adjust Knob
- K Telescoping Pole Latches
- L Trigger
- M Trigger Reel Assembly
- N Wingnut
- P Latch Thumb Knobs

# SETUP

Before installing or removing the spray gun from the Gun Holder, relieve pressure in the system by following the **Pressure Relief Procedure** in the sprayer manual.

## INSTALL SPRAY GUN

Properly install and remove a spray gun on the ProReach™ Telescoping Spray Pole.

1. Perform the **Pressure Relief Procedure** found in the sprayer manual.
2. Connect hose to the spray gun.
3. Install the spray gun onto the Gun Holder.
  - a. Ensure the trigger lock on the spray gun is set to the **LOCK** position. See the **Trigger Lock** section of the sprayer manual for instructions on how to operate the gun trigger lock.
  - b. Loosen the Gun Clamp Knob (H) on the Gun Clamp Arm (G) and slide to the back of the slot.

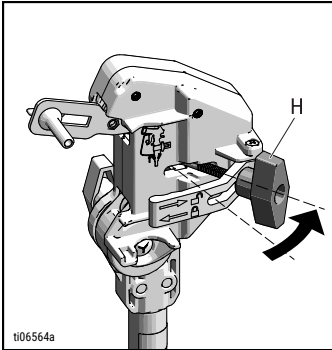

- c. Place the spray gun under the Gun Clamp Arm (G). Allow the trigger guard to rest on the Gun Swivel Holder (F). Ensure the Gun Trigger Actuator (D) is resting on the front side of the trigger.

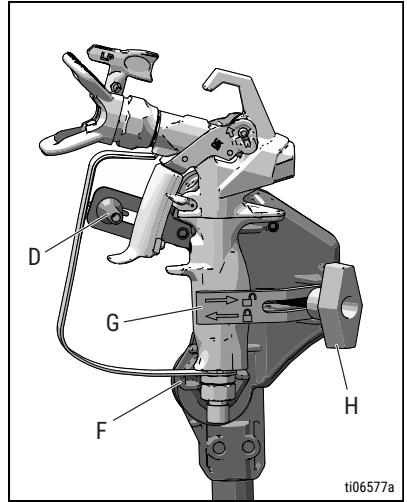

- d. Slide the Gun Clamp Knob (H) on the Gun Clamp Arm (G) to the front of the slot and tighten until gun is secure. Do not overtighten Gun Clamp Knob (H).

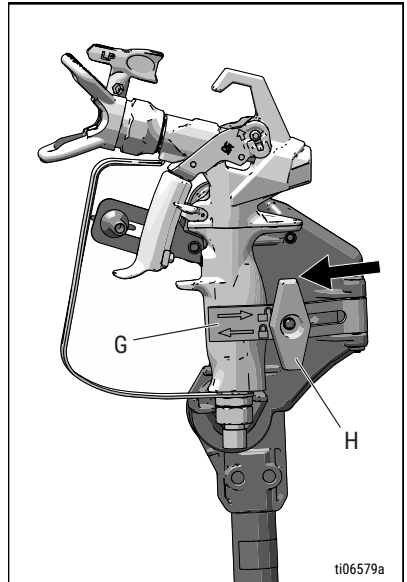

## SETUP

4. Ensure the back side of the gun is resting in the V-shaped notch at the top side of the Gun Holder (A).

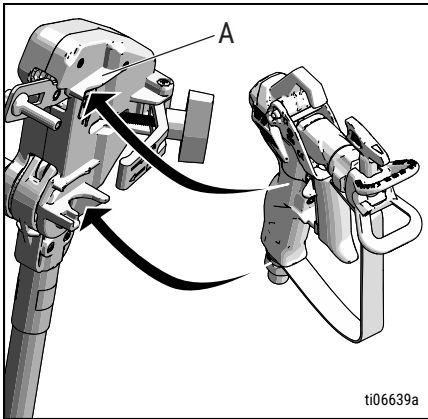



5. Adjust the Gun Trigger Actuator (D).

- a. Loosen the Wingnut (N) so that the Gun Trigger Actuator (D) can be adjusted.
- b. Disengage trigger lock on the spray gun. See the **Trigger Lock** section of the gun manual for instructions on how to operate the trigger lock.

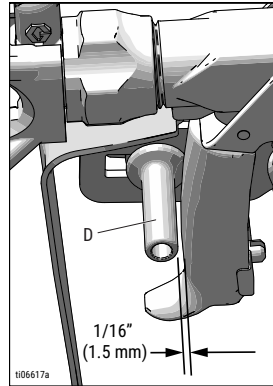
- c. Adjust the Gun Trigger Actuator (D) until the bolt is positioned with a small gap (1/16 in., or 1.5 mm) between the trigger and the actuator when the gun is not being actuated. The actuator should not touch the trigger. If the Gun Trigger Actuator (D) is resting on the gun trigger (when the gun is not being actuated), it can prevent the gun from properly shutting off.



<b>WARNING</b>				
				
<p>To help prevent injury from skin injection and splashing fluid, adjust the Gun Trigger Actuator (D) to allow the gun to shutoff when the trigger is released</p>				

- d. Tighten the Wingnut (N) to lock the actuator in position.
6. Route the spray hose through the Hose Carabiner (C) on the trigger assembly.



### NOTE:

The Gun Holder (A) orientation can be flipped 180°. To change the orientation: remove the two screws at the bottom of the Gun Holder (A). Pull the Gun Holder (A) off the pole. Reverse the Gun Holder (A) 180°. Reinstall the Gun Holder (A) on the pole and tighten the two screws.

# OPERATION

The instructions provide guidance on how to use the ProReach™ Telescoping Spray Pole.

WARNING				
				
<p>To reduce the risk of injury from skin injection, ensure there is slack in the spray hose when operating the ProReach. Do not yank the hose or pull the hose taught with the ProReach. Do not drag the sprayer with the sprayer hose or the ProReach.</p>				

WARNING				
				
<p>To avoid serious injury, do not spray at pressures above 3600 psi (24.8 MPa, 248 bar). Spraying above this limit may cause:</p> <ul style="list-style-type: none"><li>• Loss of equipment control, leading to falls and trips.</li><li>• The pole to break, which might result in lacerations or bruises.</li></ul>				

## OPERATE THE PROREACH™ TELESCOPING POLE

Relieve pressure on the spray gun when operation is stopped, and before cleaning, checking, or servicing the equipment.

### NOTE:

Do not retract the pole while the trigger is engaged. Doing so may result in the cable becoming unspooled from the Trigger Reel Assembly (M).

1. Rotate Gun Holder to desired angle.
  - a. Turn Angle Adjust Knob (H) counterclockwise to loosen, then rotate Gun Holder to desired spray angle. If desired, turn Angle Adjust Knob clockwise to lock the spray angle.

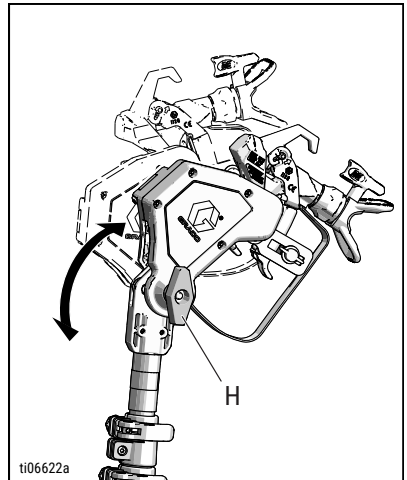

- To adjust the length, disengage Telescoping Pole Latches (K). Slide the tubes in or out to the desired length. Engage the Telescoping Pole Latches to lock the length.

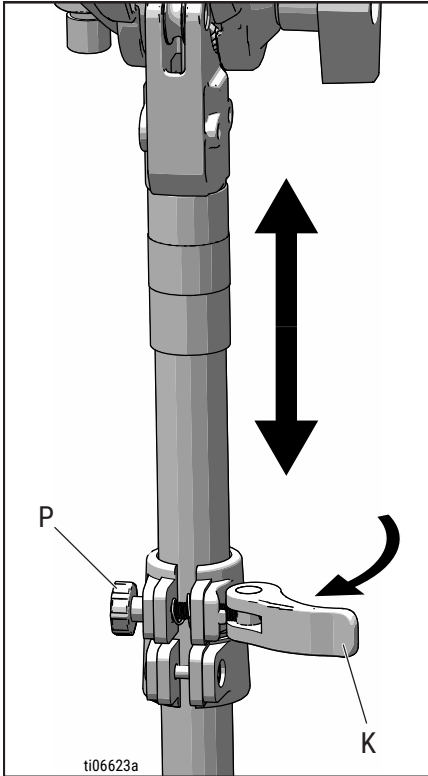

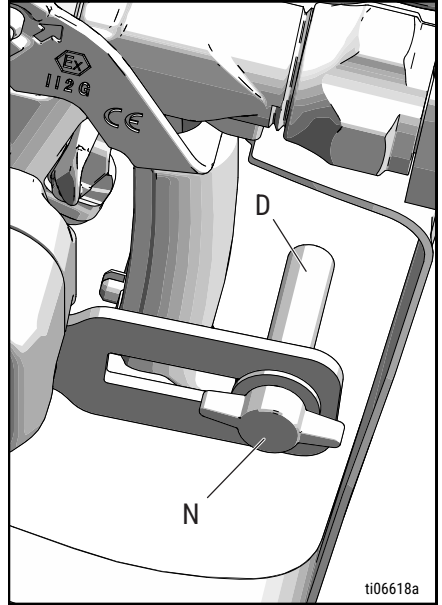

## REMOVE SPRAY GUN FROM POLE

- Retract the pole.
- Adjust and move Gun Trigger Actuator (D) to the end of the slot.



- Engage the trigger lock on the spray gun. See the **Trigger Lock** section in the spray gun manual.
- Remove the spray gun from the Gun Holder, and the hose from the Hose Carabiner.

 <b>WARNING</b>				
				
<p>To help reduce the risk of injury from unexpected spray, do not allow pole tube to slam down when collapsing the extension pole or using the ProReach.</p>				

- If needed, tighten Telescoping Pole Latches (K) by turning latch thumb knobs (P) clockwise while the latches are disengaged. If Latch Thumb Knobs are too loose, the pole will retract when the trigger is pulled.
- Pull Trigger to spray.

## MAINTENANCE

---

Follow the service schedule to keep the ProReach™ Telescoping Spray Pole in good condition for optimal use.

After each use, wipe the ProReach components clean with a damp cloth.

### **NOTICE**

Do not soak the ProReach in solvent. Prolonged exposure to solvent can damage the internal components.

### **NOTICE**

Do not remove shroud from the trigger reel assembly. Doing so can cause damage to the coiled spring inside the reel.

## END OF PRODUCT LIFE

Properly recycle and dispose of the ProReach™ Telescoping Spray Pole at the end of its useful life.

## CALIFORNIA PROPOSITION 65

### CALIFORNIA RESIDENTS



**WARNING** Cancer and reproductive harm – [www.P65warnings.ca.gov](http://www.P65warnings.ca.gov).

# TROUBLESHOOTING

When problems occur, use the table to identify potential causes and solutions to repair the ProReach™ Telescoping Spray Pole.

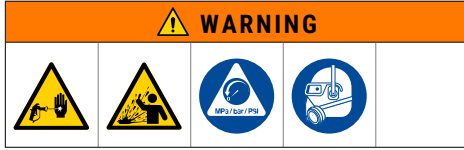

## NOTE:

Check all possible problems and causes before disassembling the equipment.

PROBLEM	CAUSE	SOLUTION
Spray gun has poor or no shutoff.	Spray gun is not correctly set up in the Gun Holder.	Adjust the position of the gun the Gun Holder and check the position of the Gun Trigger Actuator (approximately 1/16 in. from the spray gun trigger). Ensure the gun is properly tightened in position. See <b>Gun Installation</b> .
	Trigger linkage inside the Gun Holder has paint buildup.	Remove the gun holder shroud and, using a damp cloth, clean the trigger linkage.
	Trigger is not disengaging with the Trigger Reel Assembly.	Slightly adjust the length of one of the pole tubes.
	Spray gun is not supported by ProReach.	Replace with a supported spray gun.
	Trigger is damaged.	Replace the trigger.
	Trigger linkage inside the Gun Holder is damaged.	Replace the Gun Holder Assembly.
	Trigger Reel Assembly or cable is damaged.	Replace Trigger Reel/pole assembly.
Spray gun does not spray.	Spray gun is not setup in the Gun Holder correctly.	Adjust the position of the gun in the Gun Holder and check the position of the Gun Trigger Actuator (approximately 1/16 in. from the spray gun trigger). Ensure the gun is properly tightened in position. See <b>Gun Installation</b> .
	Telescoping Pole Latches are not tight enough, causing pole tubes to retract when the trigger is pulled.	Tighten the thumb knobs on the Telescoping Pole Latches. See <b>Gun Installation</b> .
	Spray gun trigger lock is engaged.	Disengage the trigger lock on the spray gun.
	Gun Holder changes spray angle when trigger is pulled.	Tighten the Angle Adjust Knob at the desired spray angle.

## TROUBLESHOOTING

PROBLEM	CAUSE	SOLUTION
	Spray gun is not supported by ProReach.	Replace with a supported spray gun.
	Trigger was engaged while pole was retracted.	Fully extend all pole sections. Lock telescoping pole latches. Pull trigger five to ten times. Retract pole.
	Trigger is damaged.	Replace the trigger.
	Trigger linkage inside the Gun Holder is damaged.	Replace the Gun Holder Assembly.
	Trigger Reel Assembly or cable is damaged.	Replace Trigger Reel/pole assembly.
Pole does not properly telescope.	Telescoping Pole Latches are engaged.	Disengage Telescoping Pole Latches before extending or retracting the pole.
	Trigger was engaged while pole was retracted.	Fully extend all pole sections. Lock telescoping pole latches. Pull trigger five to ten times. Retract pole.
	Paint buildup on the pole tubes are preventing smooth telescoping.	Clean pole tubes with a damp cloth.
	ProReach trigger is engaged.	Disengage the ProReach trigger.
	Damaged Telescoping Pole Latches.	Replace Telescoping Pole Latches.
Gun Holder does not hold its position in the unlocked state.	Angle Adjust Bolt is loose.	Access the lock nut by removing the two hand knobs and the four cover screws. Remove the cover and tighten the lower lock nut and the jam nut to the desired resistance. Then replace the cover and the two hand knobs.

# REPAIR

When replacing parts, follow the instructions to restore the components on the ProReach™ Telescoping Spray Pole.

## REPLACE TRIGGER

### NOTICE

Do not remove the Trigger Reel Assembly Shroud (M). Doing so may result in damage to the recoil spring.

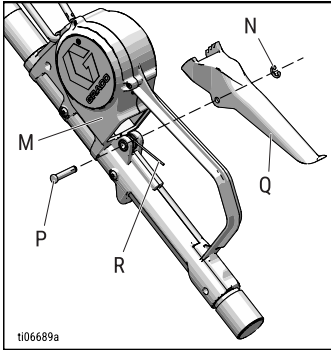

1. Follow **Remove Spray Gun from Pole** procedure.
2. Remove e-clip (N) and clevis pin (P).
3. Remove Trigger (Q).
4. Install new Trigger (ensure spring (R) is properly installed in the groove of the trigger).
5. Install new clevis pin (P) and e-clip (N).

## CLEAN OR REMOVE GUN HOLDER AND POLE/TRIGGER ASSEMBLY

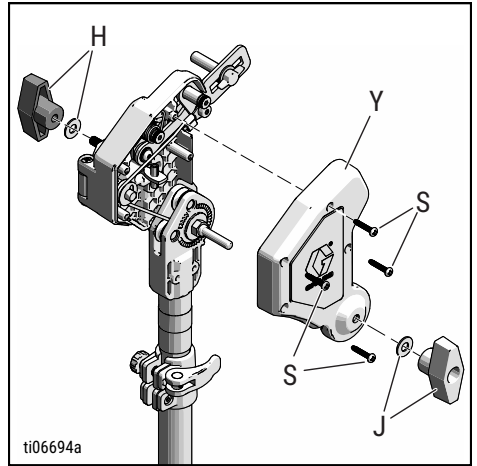

ti06694a

1. Follow **Remove Spray Gun from Pole** procedure.
2. Remove Gun Clamp Knob (H), washers (H), and Angle Adjust Knob (J).
3. Remove four clamshell screws (S).
4. Remove shroud cover (Y).
5. Remove gun holder angle adjust bolt (T), washers (U), and nuts (U).

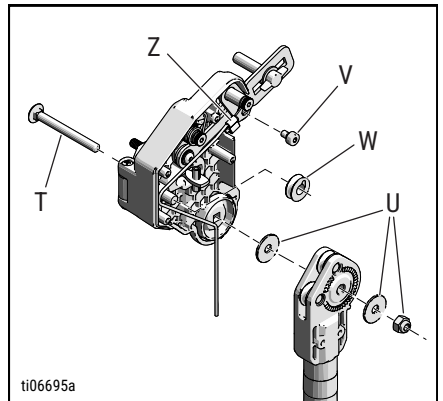

ti06695a

6. Clean internal components with a damp cloth. If replacement is needed, proceed to the next step. If no replacement is needed, reassemble Gun Holder.

7. Disconnect cable terminal (Z) by removing shoulder bolt (V).
8. Remove pulley (W) inside Gun Holder.

**INSTALL NEW GUN HOLDER AND POLE/TRIGGER ASSEMBLY**

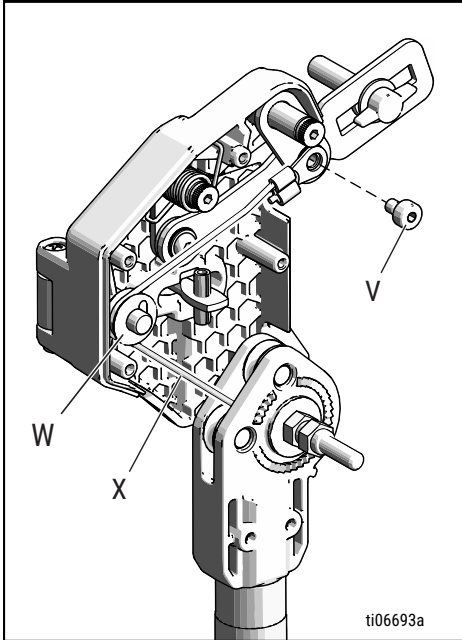

2. Torque gun holder angle adjust bolt (T), washers, lower adjustment nut, and jam nut (U). Torque both nuts to 40 in-lb (4.5 N-m), or to the desired Gun Holder angle adjust resistance.
3. Connect new cable (X) to gun holder linkage shoulder bolt (V).
4. Route new cable (X) through pulley (W).
5. Install shroud cover (Y) and torque four screws (S) to 15 in-lb (1.7 N-m).
6. Install new Gun Clamp Knob (H), Angle Adjust Knob (J), and washers.

1. Torque new gun holder angle adjust bolt (T), washers, lower adjustment nut, and jam nut (U). Torque both nuts to 40 in-lb (4.5 N-m), or to the desired Gun Holder angle adjust resistance.
2. Connect cable (X) to new gun holder linkage shoulder bolt (V).
3. Route cable (X) through new pulley (W).
4. Install new shroud cover (Y) and torque four screws (S) to 15 in-lb (1.7 N-m).
5. Install new Gun Clamp Knob (H), Angle Adjust Knob (J), and washers.

**INSTALL NEW POLE/TRIGGER/CABLE ASSEMBLY**

1. Follow **Clean or Remove Gun Holder and Pole/Trigger Assembly** procedure.

# PROREACH™ TELESCOPING SPRAY POLE PARTS

The parts illustration and list identify the components of the ProReach™ Telescoping Spray Pole and show the connections that are required for assembly, repair, and maintenance.

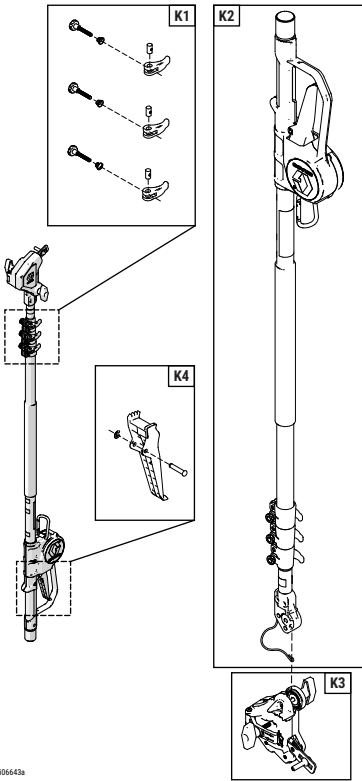

Figure 10-1: ProReach Telescoping Spray Pole Parts

## PARTS LIST

REF.	PART	DESCRIPTION	QTY.
K1	2016608	KIT, repair, latches	1
K2	2016606	KIT, repair, pole/trigger/cable assembly	1
K3	2016605	KIT, repair, gun holder assembly	1
K4	2016607	KIT, repair, trigger	1
▲	2016609*	KIT, repair, labels (not shown)	1

REF.	PART	DESCRIPTION	QTY.
▲	2016139*	LABEL, warning, safety	1
▲	222385*	CARD, medical alert, safety	1

\* Not shown

▲ Replacement safety labels, tags, and cards are available at no cost.

PROREACH™ TELESCOPING SPRAY POLE PARTS

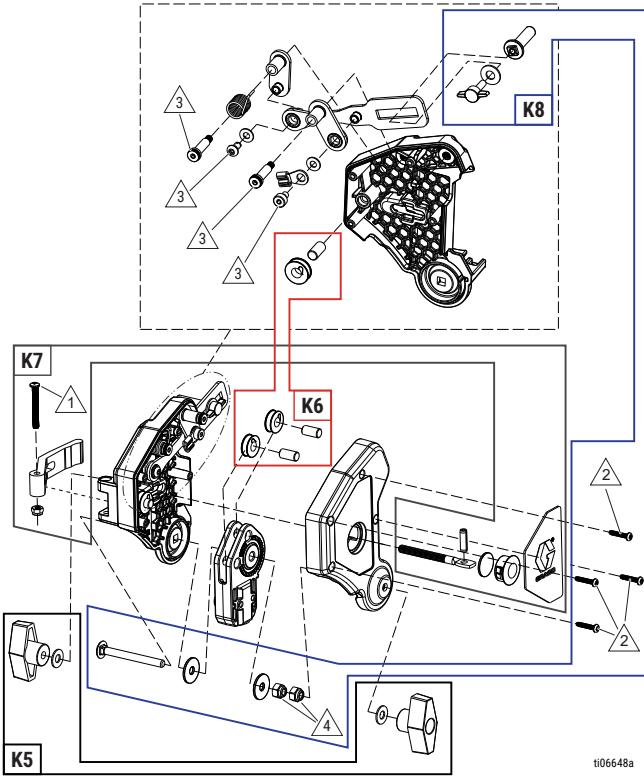

Figure 10-2: ProReach Gun Holder Parts

1  $4 \pm 1$  in-lb ( $0.45 \pm 0.1$  N·m)

3  $22 \pm 2$  in-lb ( $2.5 \pm 0.2$  N·m)

2  $15 \pm 1$  in-lb ( $1.7 \pm 0.1$  N·m)

4  $40 \pm 5$  in-lb ( $4.5 \pm 0.6$  N·m) or to the desired torque for Gun Holder angle adjust resistance.

**PARTS LIST**

REF.	PART	DESCRIPTION	QTY.
K5	2016601	KIT, repair, knobs	1
K6	2016602	KIT, repair, rollers	1
K7	2016603	KIT, repair, gun clamp	1
K8	2016604	KIT, repair, gun head hardware	1

# GRACO STANDARD WARRANTY

---

Graco warrants all equipment referenced in this document which is manufactured by Graco and bearing its name to be free from defects in material and workmanship on the date of sale to the original purchaser for use. With the exception of any special, extended, or limited warranty published by Graco, Graco will, for a period of twelve months from the date of sale, repair or replace any part of the equipment determined by Graco to be defective. This warranty applies only when the equipment is installed, operated and maintained in accordance with Graco's written recommendations.

This warranty does not cover, and Graco shall not be liable for general wear and tear, or any malfunction, damage or wear caused by faulty installation, misapplication, abrasion, corrosion, inadequate or improper maintenance, negligence, accident, tampering, or substitution of non-Graco component parts. Nor shall Graco be liable for malfunction, damage or wear caused by the incompatibility of Graco equipment with structures, accessories, equipment or materials not supplied by Graco, or the improper design, manufacture, installation, operation or maintenance of structures, accessories, equipment or materials not supplied by Graco.

This warranty is conditioned upon the prepaid return of the equipment claimed to be defective to an authorized Graco distributor for verification of the claimed defect. If the claimed defect is verified, Graco will repair or replace free of charge any defective parts. The equipment will be returned to the original purchaser transportation prepaid. If inspection of the equipment does not disclose any defect in material or workmanship, repairs will be made at a reasonable charge, which charges may include the costs of parts, labor, and transportation.

**THIS WARRANTY IS EXCLUSIVE, AND IS IN LIEU OF ANY OTHER WARRANTIES, EXPRESS OR IMPLIED, INCLUDING BUT NOT LIMITED TO WARRANTY OF MERCHANTABILITY OR WARRANTY OF FITNESS FOR A PARTICULAR PURPOSE.** Graco's sole obligation and buyer's sole remedy for any breach of warranty shall be as set forth above. The buyer agrees that no other remedy (including, but not limited to, incidental or consequential damages for lost profits, lost sales, injury to person or property, or any other incidental or consequential loss) shall be available. Any action for breach of warranty must be brought within two (2) years of the date of sale.

**GRACO MAKES NO WARRANTY, AND DISCLAIMS ALL IMPLIED WARRANTIES OF MERCHANTABILITY AND FITNESS FOR A PARTICULAR PURPOSE, IN CONNECTION WITH ACCESSORIES, EQUIPMENT, MATERIALS OR COMPONENTS SOLD BUT NOT MANUFACTURED BY GRACO.** These items sold, but not manufactured by Graco (such as electric motors, switches, hose, etc.), are subject to the warranty, if any, of their manufacturer. Graco will provide purchaser with reasonable assistance in making any claim for breach of these warranties.

In no event will Graco be liable for indirect, incidental, special or consequential damages resulting from Graco supplying equipment hereunder, or the furnishing, performance, or use of any products or other goods sold hereto, whether due to a breach of contract, breach of warranty, the negligence of Graco, or otherwise.

**FOR GRACO CANADA CUSTOMERS** The Parties acknowledge that they have required that the present document, as well as all documents, notices and legal proceedings entered into, given or instituted pursuant hereto or relating directly or indirectly hereto, be drawn up in English. Les parties reconnaissent avoir convenu que la rédaction du présente document sera en Anglais, ainsi que tous documents, avis et procédures judiciaires exécutés, donnés ou intentés, à la suite de ou en rapport, directement ou indirectement, avec les procédures concernées.

**GRACO INC. AND SUBSIDIARIES | P.O. BOX 1441 | MINNEAPOLIS MN 55440-1441 | USA**

Graco Headquarters: Minneapolis, MN USA | International Offices: Australia, Belgium, China, Japan, Korea | Toll Free Phone Number: 1-800-690-2894 (Contractor Division) and 1-800-328-0211 (Industrial Division) | For patent information, see [graco.com/patents](http://graco.com/patents)

©2026 Graco Inc. All written and visual data in this document are based on the latest product information available at the time of publication. Graco reserves the right to make changes at any time without notice. All Graco manufacturing locations maintain ISO 9001:2015 certifications, each certified by accredited certification bodies. Revision B.